

PRODUCT CATALOG

Pillar cam

↗ 2019.21.

precision is our standard

Pillar cam FPC 2019.21.

With our sleeve series 20.19.21 we offer you an interesting and economically attractive alternative for installation solutions. The sleeve of our sleeve sliders is guided with a precise dove tail prism. This guarantees a high power consumption and the exact centring of the sleeve via a very high number of pressing cycles.

The sliding surfaces are fitted with sliding plates.

Due to their design, our sleeve sliders suffice for the lowest demands for maintenance. All wearing parts are available from stock.

The installation of our sleeve sliders focuses on the existing work processes and can therefore be easily integrated into existing mounting processes. The extensive internal adjustment of self-constructed sliders is totally omitted.

Design-conditioned a turned installation of the sleeve is not possible. This prevents serious consequential damage due to collision of active elements that are twisted.

Design features:

- Guidance with precise dove tail prism
- Sliding surfaces of hardened/sintered steel
- Positive locking connections
- Installation secured against torsion
- Compact installation space

Sleeves of series FCC 2019.21 are available in widths from 50 mm to 160 mm, each in the angle variants 50-85° (measured horizontally) in gradations of 5°. The length of the sleeve we supply ex factory adjusted to your requirements. The construction-conditioned working stroke covers a wide range of possible pad strokes.

Further angles, as well as further customer-specific designs are possible on request.

Order No	Width [mm]	Performance class [kN]*	Page
2019.21.05□□.01.□□□□.0	50	140	5
2019.21.06□□.01.□□□□.0	63	140	11
2019.21.08□□.01.□□□□.0	80	140	17
2019.21.10□□.01.□□□□.0	100	250	23
2019.21.12□□.01.□□□□.0	125	350	29
2019.21.16□□.01.□□□□.0	160	450	35
Assembly instructions			43

Ordering options:

The sleeve length we adjust to 0.1 mm steps to your request, starting with a basic length of 450 mm.

Please specify the length desired in the without comma in the last four-block.

Ordering Code (example):

FIBRO Pillar cam FPC, ø 6.3mm	=	2019.21.06□□. 01. □□□□ .0
Slide angle $\epsilon = 70^\circ$	=	70.
Stroke version identifier (fix)	=	01.
Sleeve length 368,5mm	=	3685
Order No	=	2019.21.0670. 01.3685 .0

Pillar cam FPC Tolerances

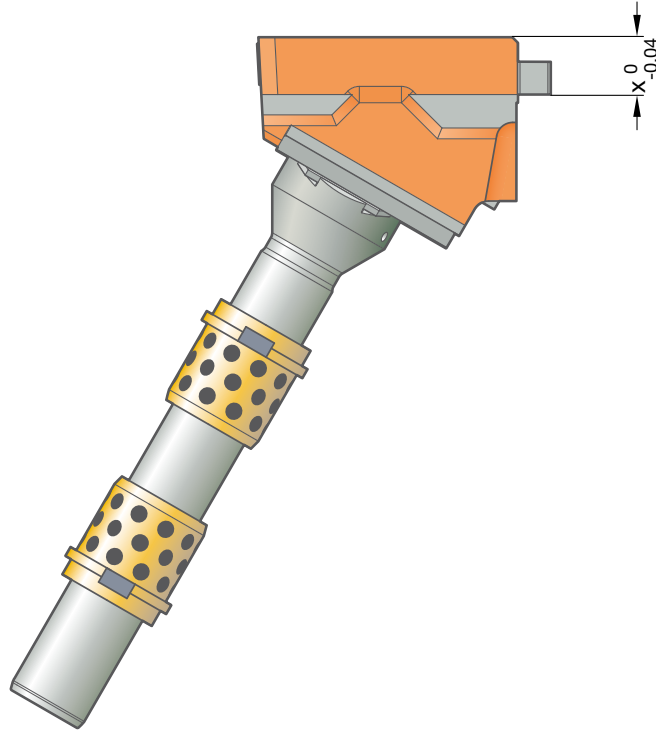

Pillar cam FPC

2019.21.05□□.

Sleeve diameter: 50 mm
Performance class: 140 kN



Pillar cam 2019.21.05□□.

Size table

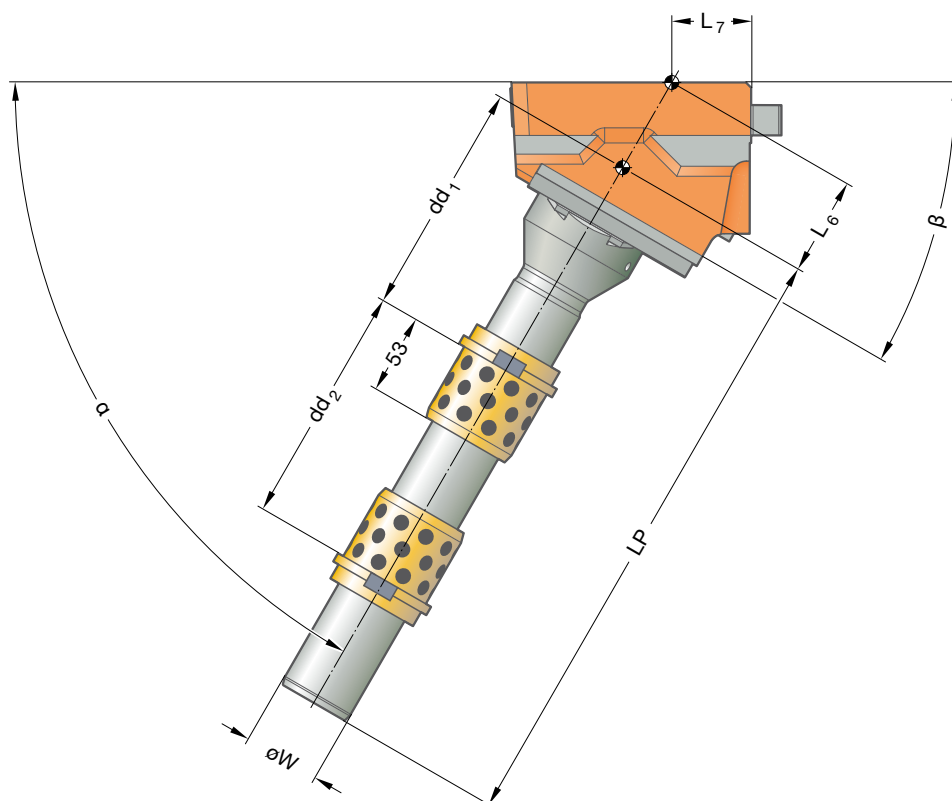
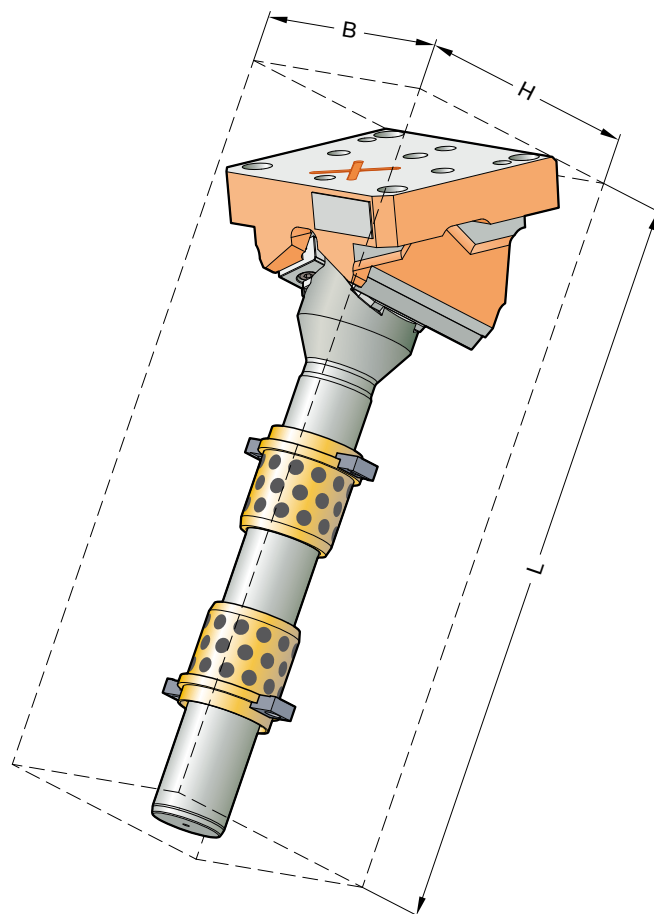

Pillar cam 2019.21.05□□.

Size table

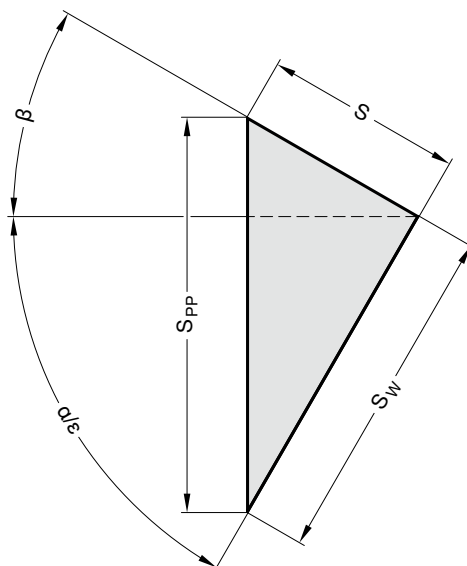

Order No.	L [mm]	B [mm]	H [mm]	øW [mm]	L _p [mm]	L ₆ [mm]	L ₇ [mm]	dd ₁ (min) [mm]	dd ₂ (min) [mm]	α [°]	β [°]	S _w (max) [mm]	S (max) [mm]	S _{PP} (max) [mm]
2019.21.0550.01.□□□□.0	552	163	193	50	175...450	84,85	45,46	110	110	50	40	69,1	58	90,2
2019.21.0555.01.□□□□.0	549	163	197	50	175...450	79,35	54,49	110	110	55	35	82,8	58	101,1
2019.21.0560.01.□□□□.0	542	163	186	50	175...450	75,06	57,47	110	110	60	30	100,5	58	116,0
2019.21.0565.01.□□□□.0	538	163	189	50	175...450	71,72	64,69	110	110	65	25	124,4	58	137,2
2019.21.0570.01.□□□□.0	532	163	179	50	175...450	69,17	71,34	110	110	70	20	159,4	58	169,6
2019.21.0575.01.□□□□.0	526	163	181	50	175...450	67,29	77,58	110	110	75	15	216,5	58	224,1
2019.21.0580.01.□□□□.0	520	163	172	50	175...450	66	83,54	110	110	80	10	328,9	58	334,0
2019.21.0585.01.□□□□.0	513	163	173	50	175...450	65,25	89,31	110	110	85	5	662,9	58	665,5

Fastening slider bed

	Quantity	Size
Socket cap screws	4	M12
Dowel pins	2	ø10

Fastening of guide bushing

	Quantity	Size
Socket cap screws	2	M6 x Number of bushings
Dowel pins		ø63

Pillar cam 2019.21.05□□.

Exploded view

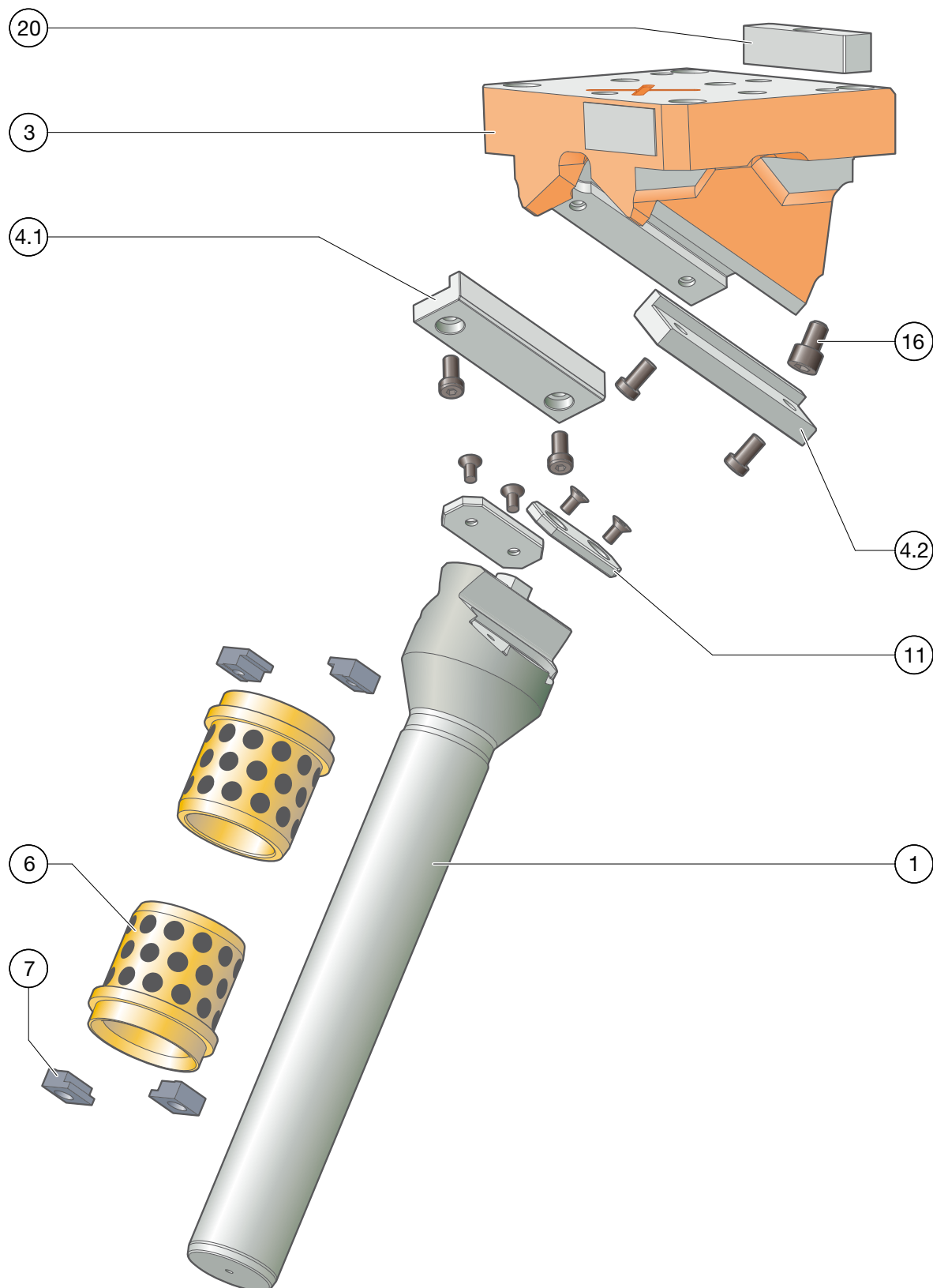

Pillar cam 2019.21.05□□.

Parts list

Item No.	piece	Designation	Material	tuned	Spare part
1	1	Sleeve	1.1221		x
2					
3	1	Cam base	EN-JS-1060		
4.1	1	L-bar left	1.1191 with sinter layer	x	x
4.2	1	L-bar right	1.1191 with sinter layer	x	x
5					
6	2	Guide bushing	Bronze with solid lubricant		x
7	4	Retaining clamp			x
8					
9					
10					
11	2	Sliding plate	1.2379		x
12					
13					
14					
15					
16	1	Drop-out safety			x
17					
18					
19					
20	1	Wedge	1.1191		x

For inquiries / orders of spare parts (x), we require the following data:

Slider order number.

Cam unit serial number

Position numberr / Designation / Spare part

Pillar cam 2019.21.05□□.

System and surrounding forces

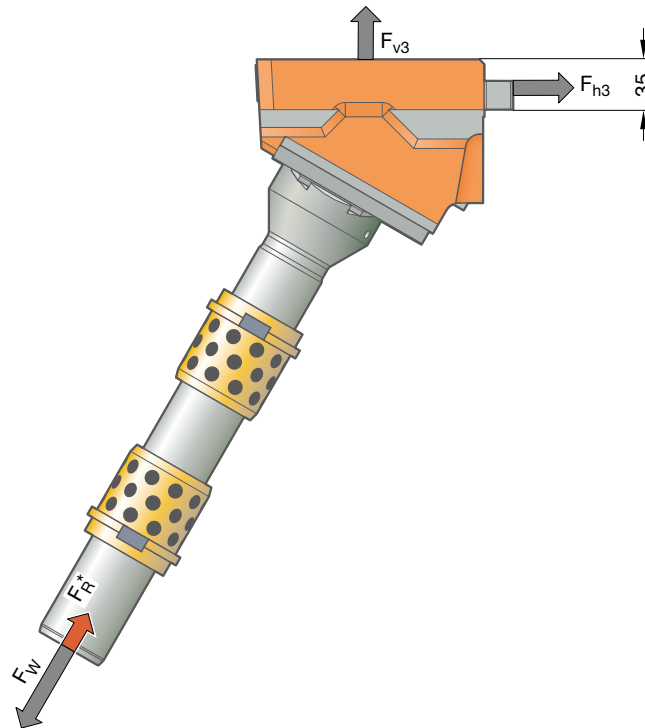

Order No.	α [°]	F_w [kN]	F_R^* [kN]	F_{h3} [kN]	F_{v3} [kN]
2019.21.0550.01.□□□□.0	50	140	25	97	101
2019.21.0555.01.□□□□.0	55	140	25	88	109
2019.21.0560.01.□□□□.0	60	140	25	78	116
2019.21.0565.01.□□□□.0	65	140	25	68	123
2019.21.0570.01.□□□□.0	70	140	25	57	128
2019.21.0575.01.□□□□.0	75	140	25	46	133
2019.21.0580.01.□□□□.0	80	140	25	34	136
2019.21.0585.01.□□□□.0	85	140	25	22	139

Pillar cam FPC

2019.21.06□□.

Sleeve diameter: 63 mm
Performance class: 140 kN

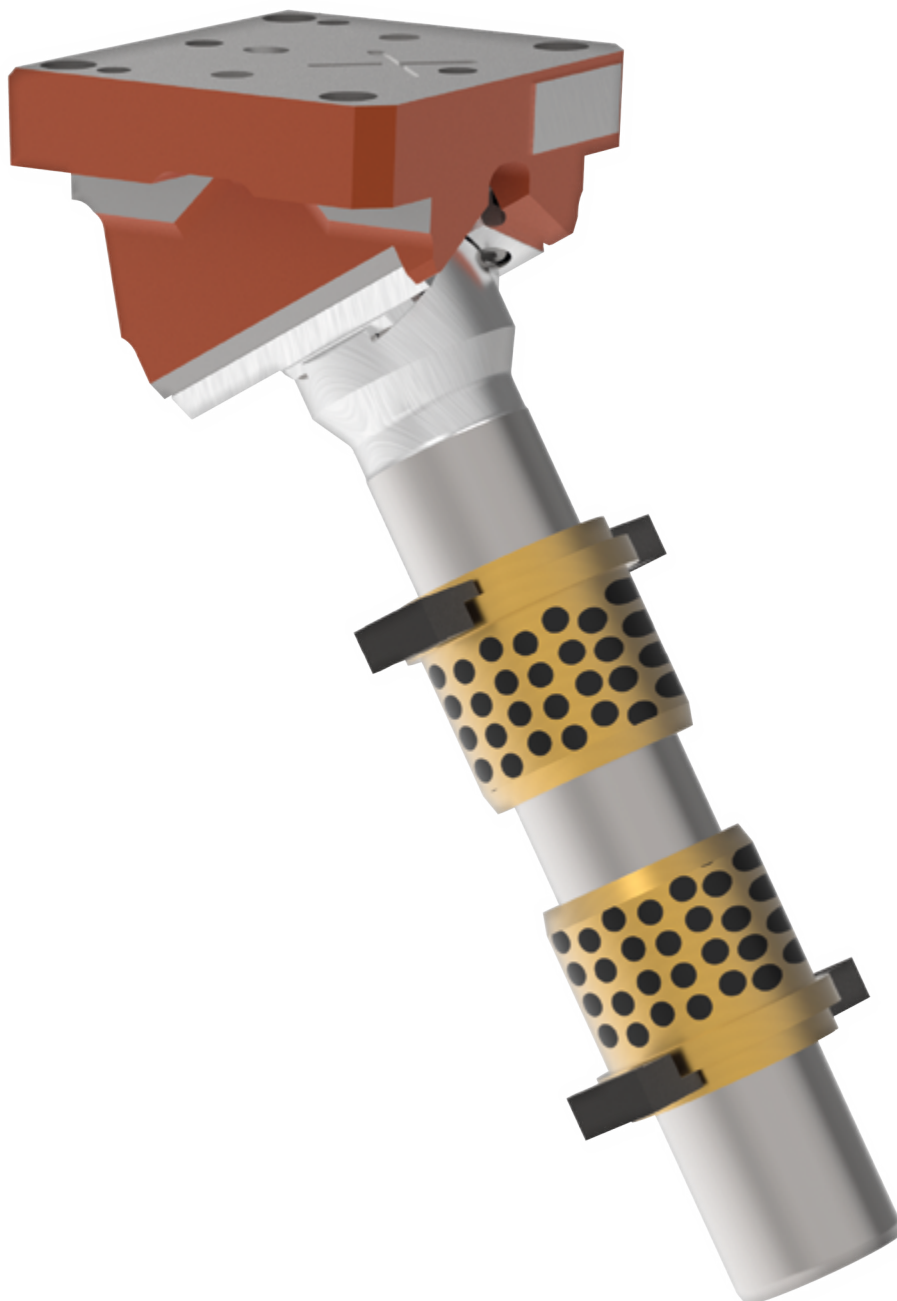

Pillar cam 2019.21.06□□.

Size table

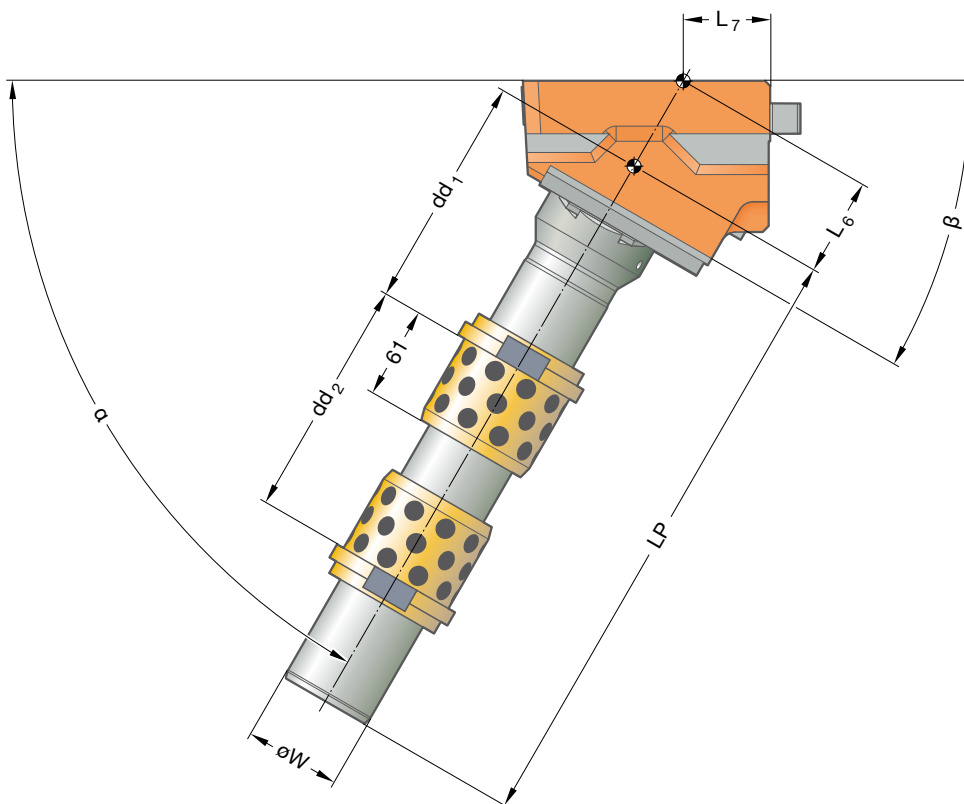
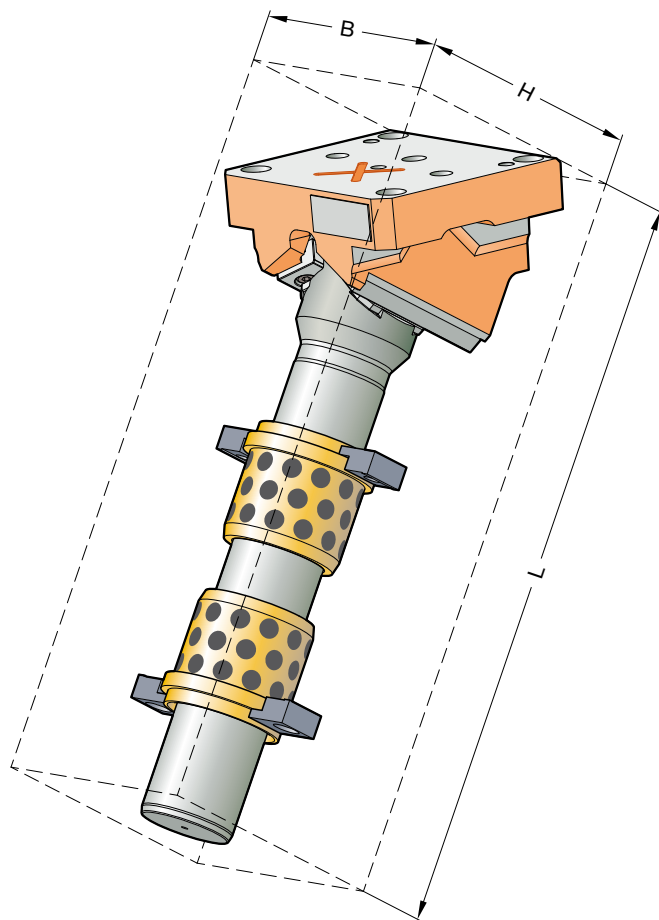

Pillar cam 2019.21.06□□.

Size table

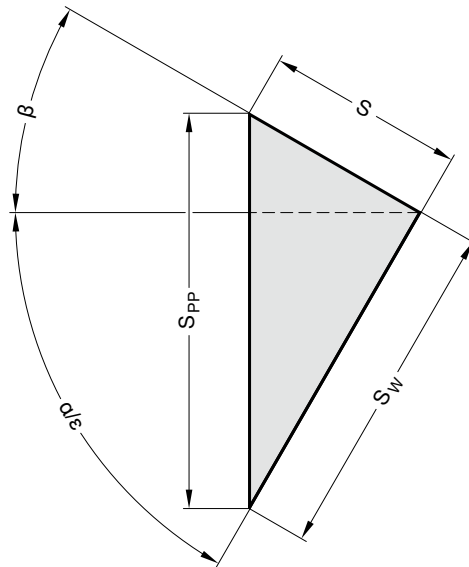

Order No.	L [mm]	B [mm]	H [mm]	øW [mm]	L _p [mm]	L ₆ [mm]	L ₇ [mm]	dd ₁ (min) [mm]	dd ₂ (min) [mm]	α [°]	β [°]	S _w (max) [mm]	S (max) [mm]	S _{PP} (max) [mm]
2019.21.0650.01.□□□□.0	552	163	193	63	185...450	84,85	45,46	110	125	50	40	69,1	58	90,2
2019.21.0655.01.□□□□.0	549	163	197	63	185...450	79,35	54,49	110	125	55	35	82,8	58	101,1
2019.21.0660.01.□□□□.0	542	163	186	63	185...450	75,06	57,47	110	125	60	30	100,5	58	116,0
2019.21.0665.01.□□□□.0	538	163	189	63	185...450	71,72	64,69	110	125	65	25	124,4	58	137,2
2019.21.0670.01.□□□□.0	532	163	179	63	185...450	69,17	71,34	110	125	70	20	159,4	58	169,6
2019.21.0675.01.□□□□.0	526	163	181	63	185...450	67,29	77,58	110	125	75	15	216,5	58	224,1
2019.21.0680.01.□□□□.0	520	163	172	63	185...450	66	83,54	110	125	80	10	328,9	58	334,0
2019.21.0685.01.□□□□.0	513	163	173	63	185...450	65,25	89,31	110	125	85	5	662,9	58	665,5

Fastening slider bed

	Quantity	Size
Socket cap screws	4	M12
Dowel pins	2	ø10

Fastening of guide bushing

	Quantity	Size
Socket cap screws	2	M10 x Number of bushings
Dowel pins		ø80

Pillar cam 2019.21.06□□.

Exploded view

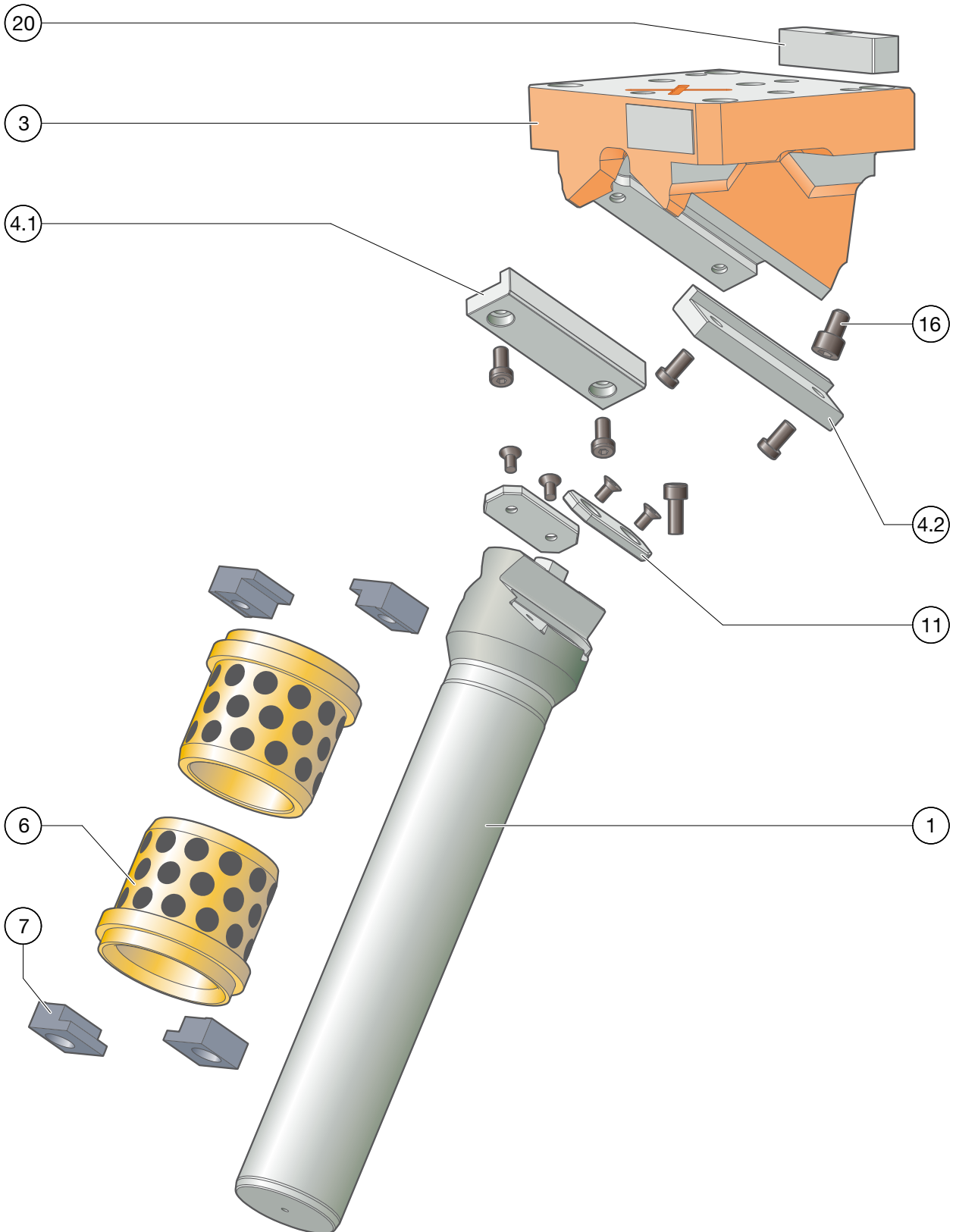

Pillar cam 2019.21.06□□.

Parts list

Item No.	piece	Designation	Material	tuned	Spare part
1	1	Sleeve	1.1221		x
2					
3	1	Cam base	EN-JS-1060		
4.1	1	L-bar left	1.1191 with sinter layer	x	x
4.2	1	L-bar right	1.1191 with sinter layer	x	x
5					
6	2	Guide bushing	Bronze with solid lubricant		x
7	4	Retaining clamp			x
8					
9					
10					
11	2	Sliding plate	1.2379		x
12					
13					
14					
15					
16	1	Drop-out safety			x
17					
18					
19					
20	1	Wedge	1.1191		x

For inquiries / orders of spare parts (x), we require the following data:

Cam unit order no.

Cam unit serial number

Position number / Designation / Spare part

Pillar cam 2019.21.06□□.

System and surrounding forces

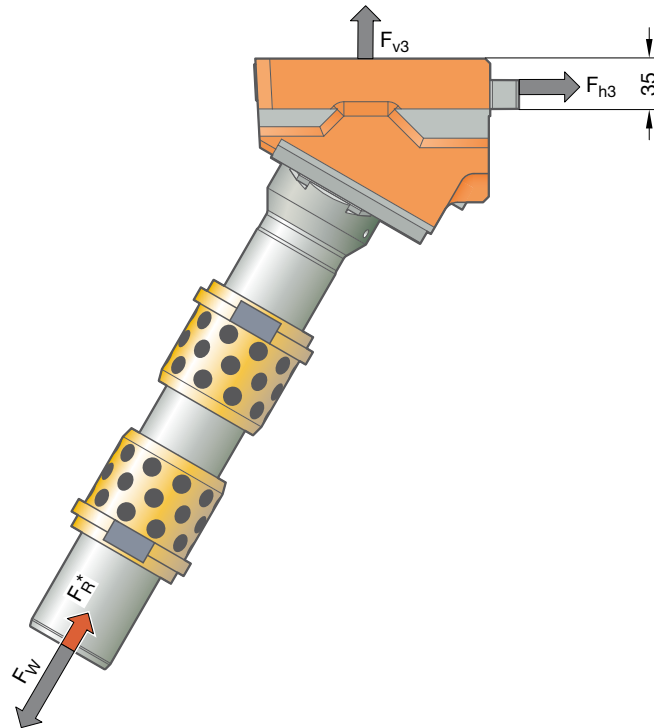

Order No.	α [°]	F_w [kN]	F_R^* [kN]	F_{h3} [kN]	F_{v3} [kN]
2019.21.0650.01.□□□□.0	50	140	25	97	101
2019.21.0655.01.□□□□.0	55	140	25	88	109
2019.21.0660.01.□□□□.0	60	140	25	78	116
2019.21.0665.01.□□□□.0	65	140	25	68	123
2019.21.0670.01.□□□□.0	70	140	25	57	128
2019.21.0675.01.□□□□.0	75	140	25	46	133
2019.21.0680.01.□□□□.0	80	140	25	34	136
2019.21.0685.01.□□□□.0	85	140	25	22	139

Pillar cam FPC

2019.21.08□□.

Sleeve diameter: 80 mm
Performance class: 140 kN

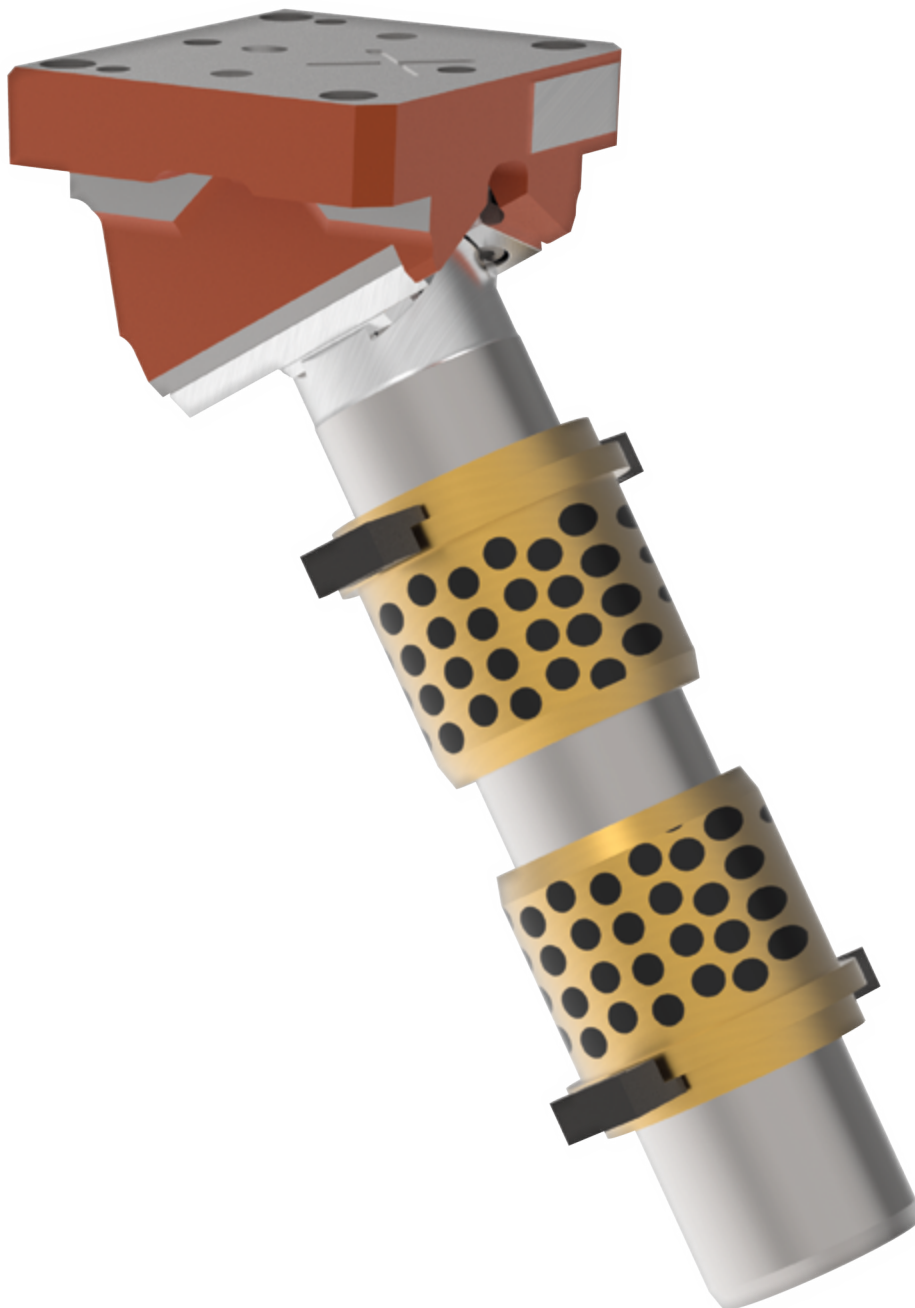

Pillar cam 2019.21.08□□.

Size table

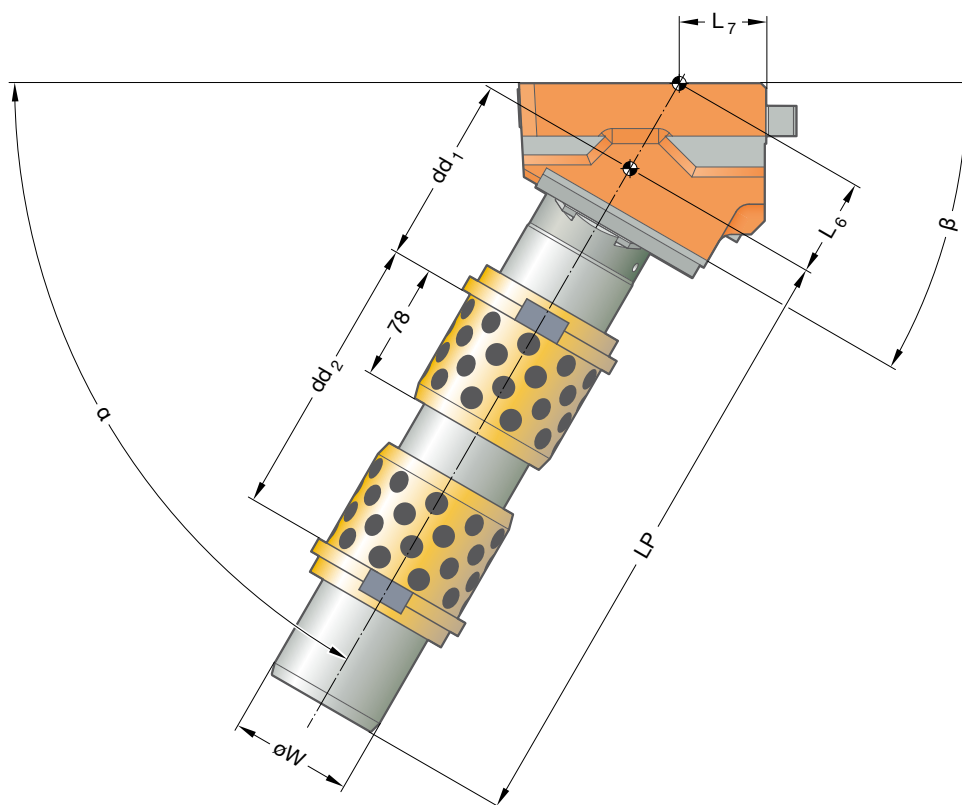
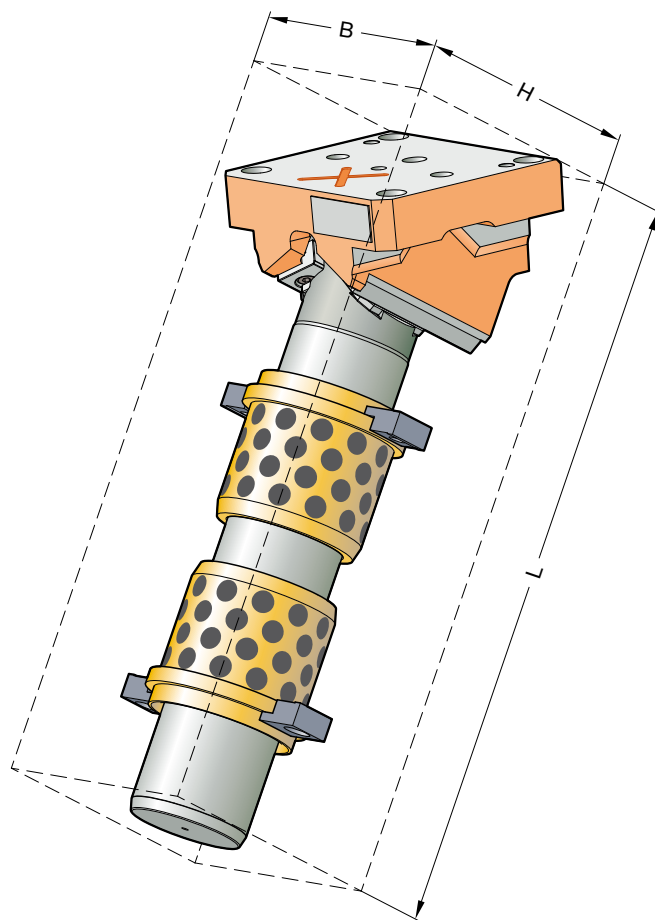

Pillar cam 2019.21.08□□.

Size table

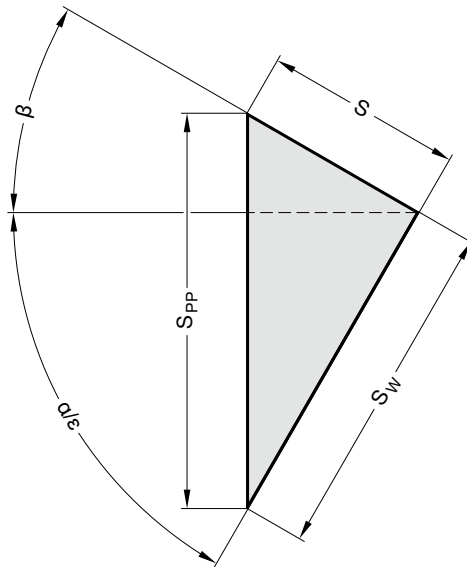

Order No.	L [mm]	B [mm]	H [mm]	øW [mm]	L _p [mm]	L ₆ [mm]	L ₇ [mm]	dd ₁ (min) [mm]	dd ₂ (min) [mm]	α [°]	β [°]	S _w (max) [mm]	S (max) [mm]	S _{PP} (max) [mm]
2019.21.0850.01.□□□□.0	552	163	193	80	200...450	84,85	45,46	110	160	50	40	69,1	58	90,2
2019.21.0855.01.□□□□.0	549	163	197	80	200...450	79,35	54,49	110	160	55	35	82,8	58	101,1
2019.21.0860.01.□□□□.0	542	163	186	80	200...450	75,06	57,47	110	160	60	30	100,5	58	116,0
2019.21.0865.01.□□□□.0	538	163	189	80	200...450	71,72	64,69	110	160	65	25	124,4	58	137,2
2019.21.0870.01.□□□□.0	532	163	179	80	200...450	69,17	71,34	110	160	70	20	159,4	58	169,6
2019.21.0875.01.□□□□.0	526	163	181	80	200...450	67,29	77,58	110	160	75	15	216,5	58	224,1
2019.21.0880.01.□□□□.0	520	163	172	80	200...450	66	83,54	110	160	80	10	328,9	58	334,0
2019.21.0885.01.□□□□.0	513	163	173	80	200...450	65,25	89,31	110	160	85	5	662,9	58	665,5

Fastening slider bed

	Quantity	Size
Socket cap screws	4	M12
Dowel pins	2	ø10

Fastening of guide bushing

	Quantity	Size
Socket cap screws	2	M10 x Number of bushings
Outside diameter bushing		ø100

Pillar cam 2019.21.08□□.

Exploded view

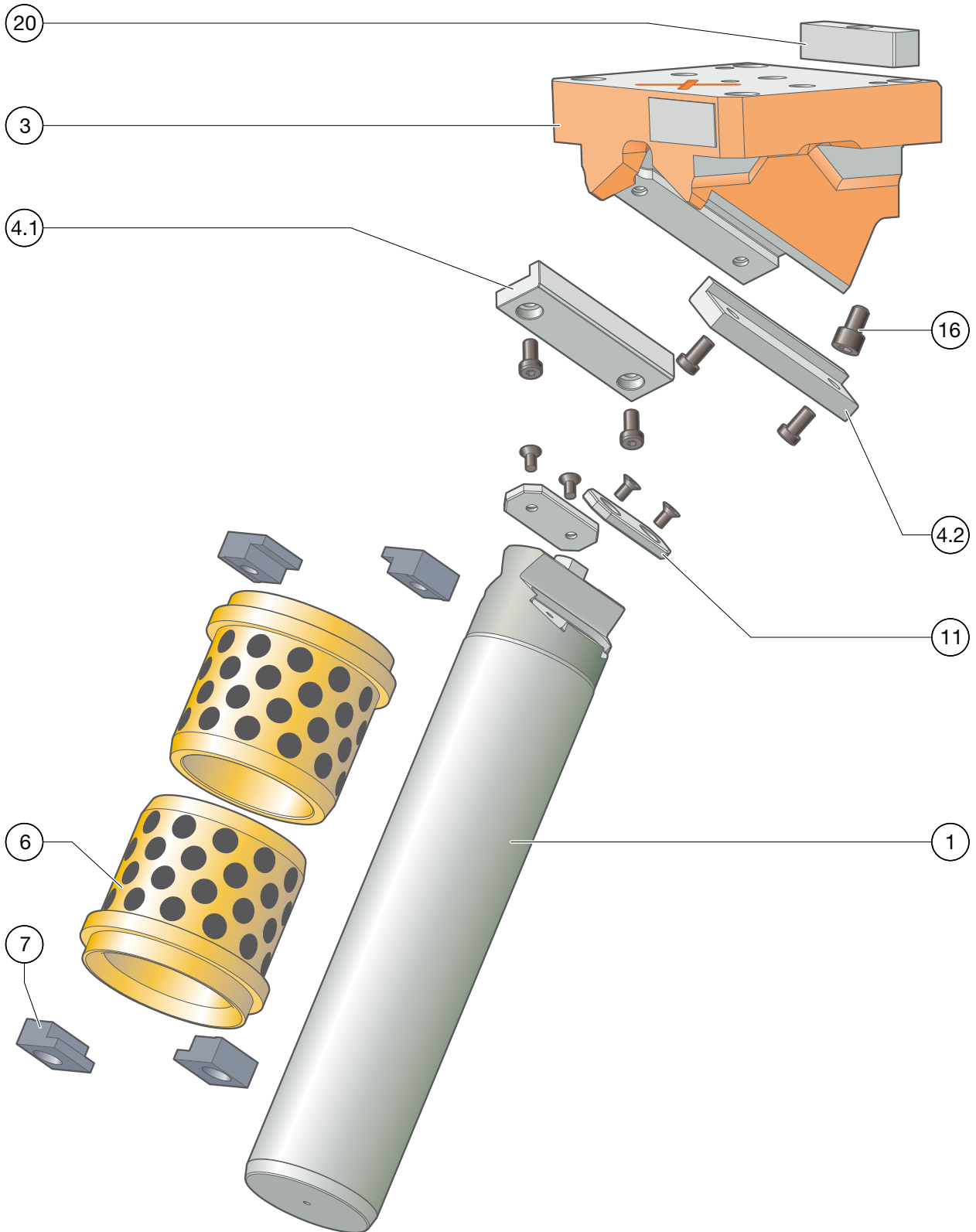

Pillar cam 2019.21.08□□.

Parts list

Item No.	piece	Designation	Material	tuned	Spare part
1	1	Sleeve	1.1221		x
2					
3	1	Cam base	EN-JS-1060		
4.1	1	L-bar left	1.1191 with sinter layer	x	x
4.2	1	L-bar right	1.1191 with sinter layer	x	x
5					
6	2	Guide bushing	Bronze with solid lubricant		x
7	4	Retaining clamp			x
8					
9					
10					
11	2	Sliding plate	1.2379		x
12					
13					
14					
15					
16	1	Drop-out safety			x
17					
18					
19					
20	1	Wedge	1.1191		x

For inquiries / orders of spare parts (x), we require the following data:

Cam unit order no.

Cam unit serial number

Position number / Designation / Spare part

Pillar cam 2019.21.08□□.

System and surrounding forces

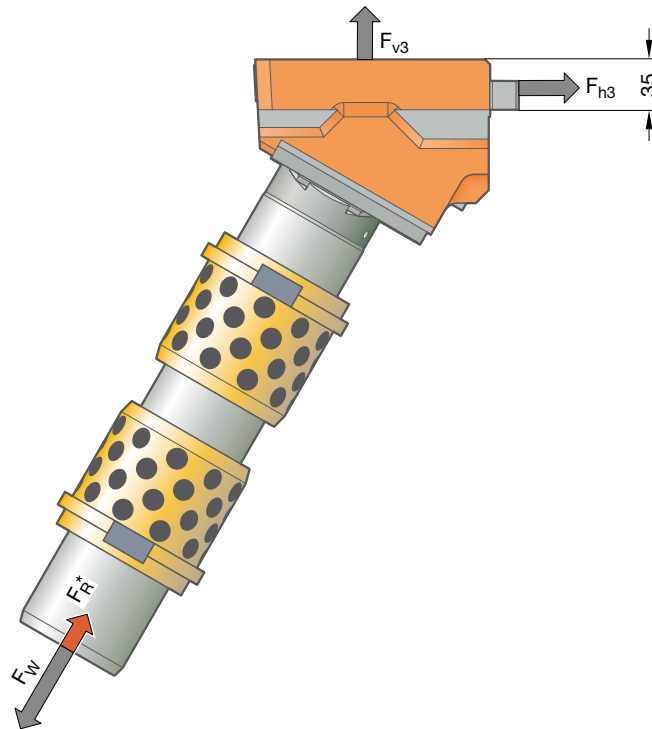

Order No.	α [°]	F_w [kN]	F_R^* [kN]	F_{h3} [kN]	F_{v3} [kN]
2019.21.0850.01.□□□□.0	50	140	25	97	101
2019.21.0855.01.□□□□.0	55	140	25	88	109
2019.21.0860.01.□□□□.0	60	140	25	78	116
2019.21.0865.01.□□□□.0	65	140	25	68	123
2019.21.0870.01.□□□□.0	70	140	25	57	128
2019.21.0875.01.□□□□.0	75	140	25	46	133
2019.21.0880.01.□□□□.0	80	140	25	34	136
2019.21.0885.01.□□□□.0	85	140	25	22	139

Pillar cam FPC

2019.21.10□□.

Sleeve diameter: 100 mm
Performance class: 260 kN

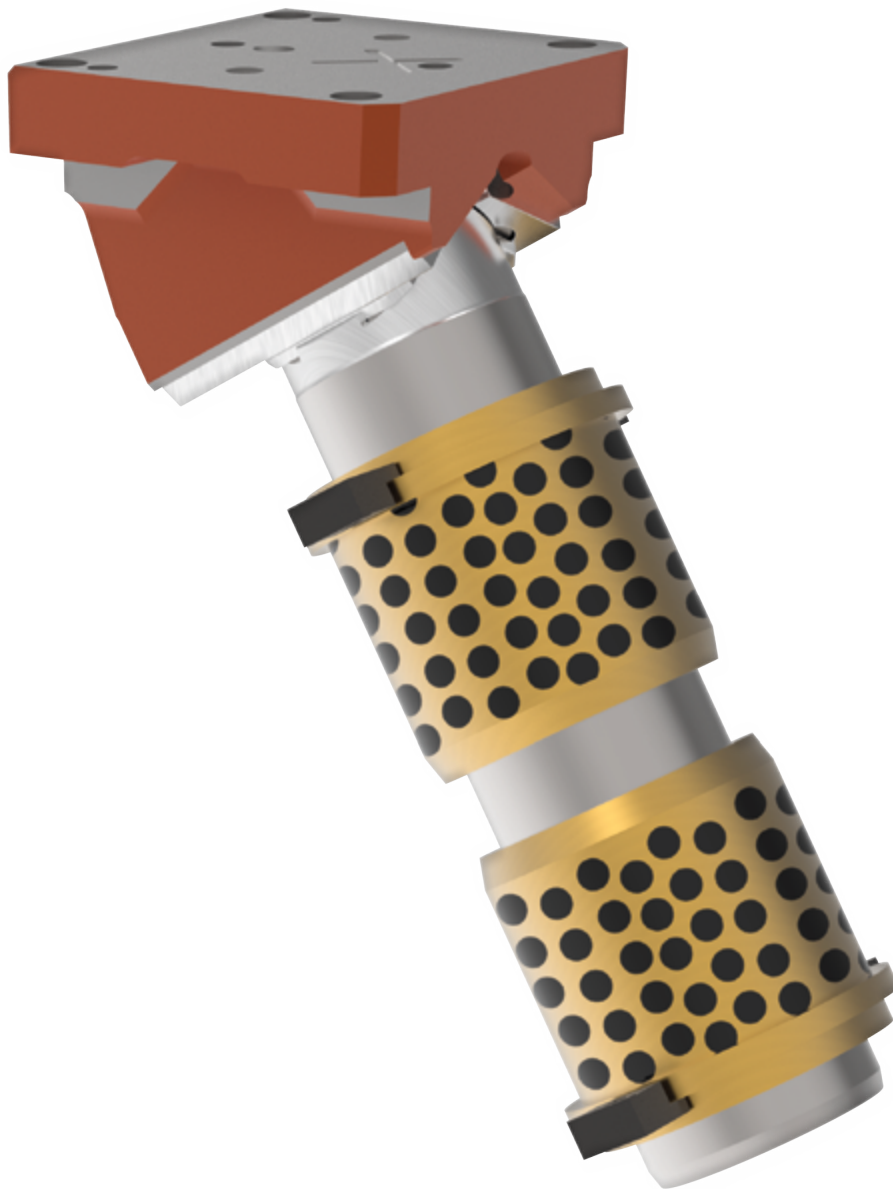

Pillar cam 2019.21.10□□.

Size table

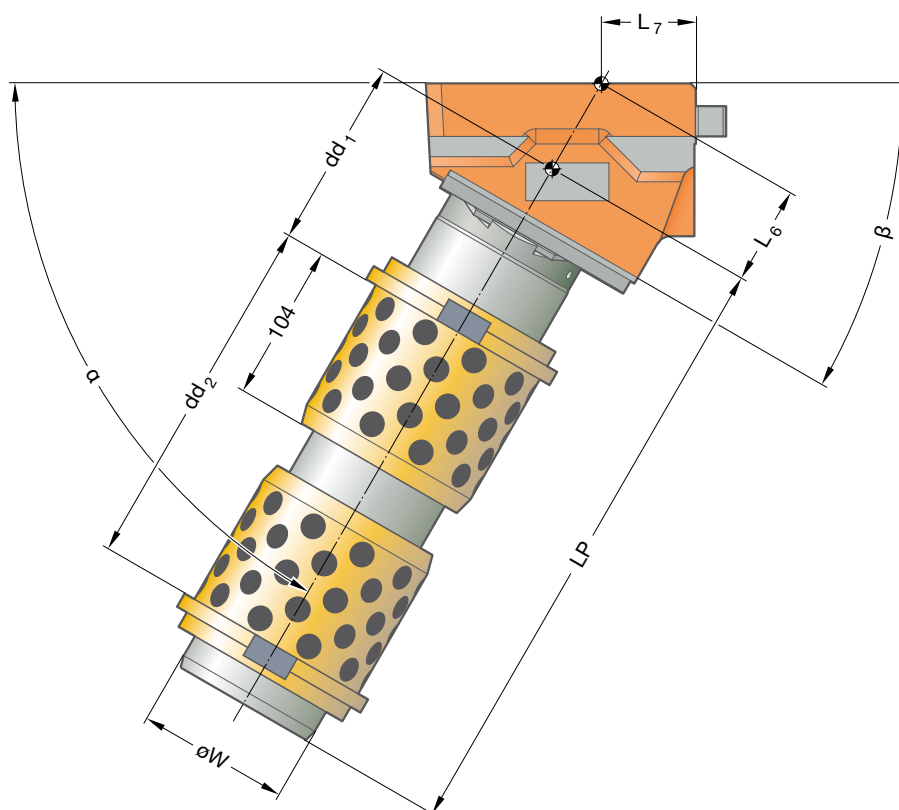
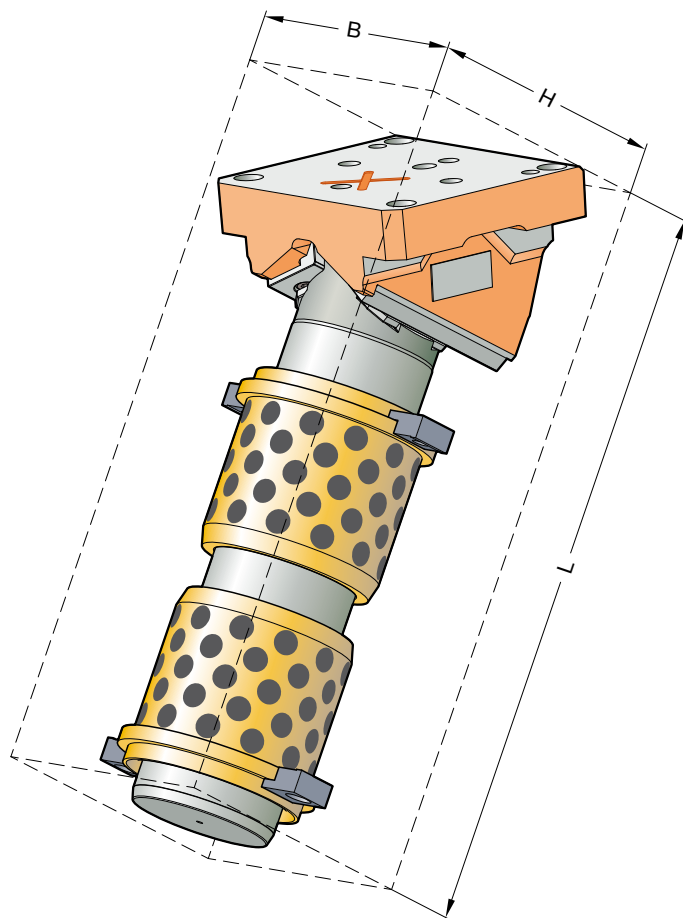

Pillar cam 2019.21.10□□.

Size table

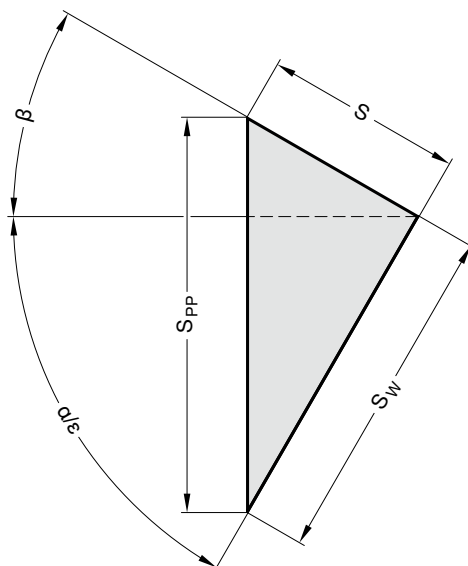

Order No.	L [mm]	B [mm]	H [mm]	øW [mm]	L _p [mm]	L ₆ [mm]	L ₇ [mm]	dd ₁ (min) [mm]	dd ₂ (min) [mm]	α [°]	β [°]	S _w (max) [mm]	S (max) [mm]	S _{PP} (max) [mm]
2019.21.1050.01.□□□□.0	577	200	218	100	230...450	104,43	62,87	110	210	50	40	69,1	58	90,2
2019.21.1055.01.□□□□.0	572	200	222	100	230...450	97,66	105,83	110	210	55	35	82,8	58	101,1
2019.21.1060.01.□□□□.0	544	200	212	100	230...450	75,06	72,47	110	210	60	30	100,5	58	116,0
2019.21.1065.01.□□□□.0	538	200	215	100	230...450	71,72	79,69	110	210	65	25	124,4	58	137,2
2019.21.1070.01.□□□□.0	532	200	209	100	230...450	69,17	86,34	110	210	70	20	159,4	58	169,6
2019.21.1075.01.□□□□.0	524	200	210	100	230...450	67,29	92,58	110	210	75	15	216,5	58	224,1
2019.21.1080.01.□□□□.0	517	200	201	100	230...450	66	98,54	110	210	80	10	328,9	58	334,0
2019.21.1085.01.□□□□.0	508	200	202	100	230...450	65,25	104,31	110	210	85	5	662,9	58	665,5

Fastening slider bed

	Quantity	Size
Socket cap screws	4	M12
Dowel pins	2	ø10

Fastening of guide bushing

	Quantity	Size
Socket cap screws	2	M10 x Number of bushings
Outside diameter bushing		ø125

Pillar cam 2019.21.10□□.

Exploded view

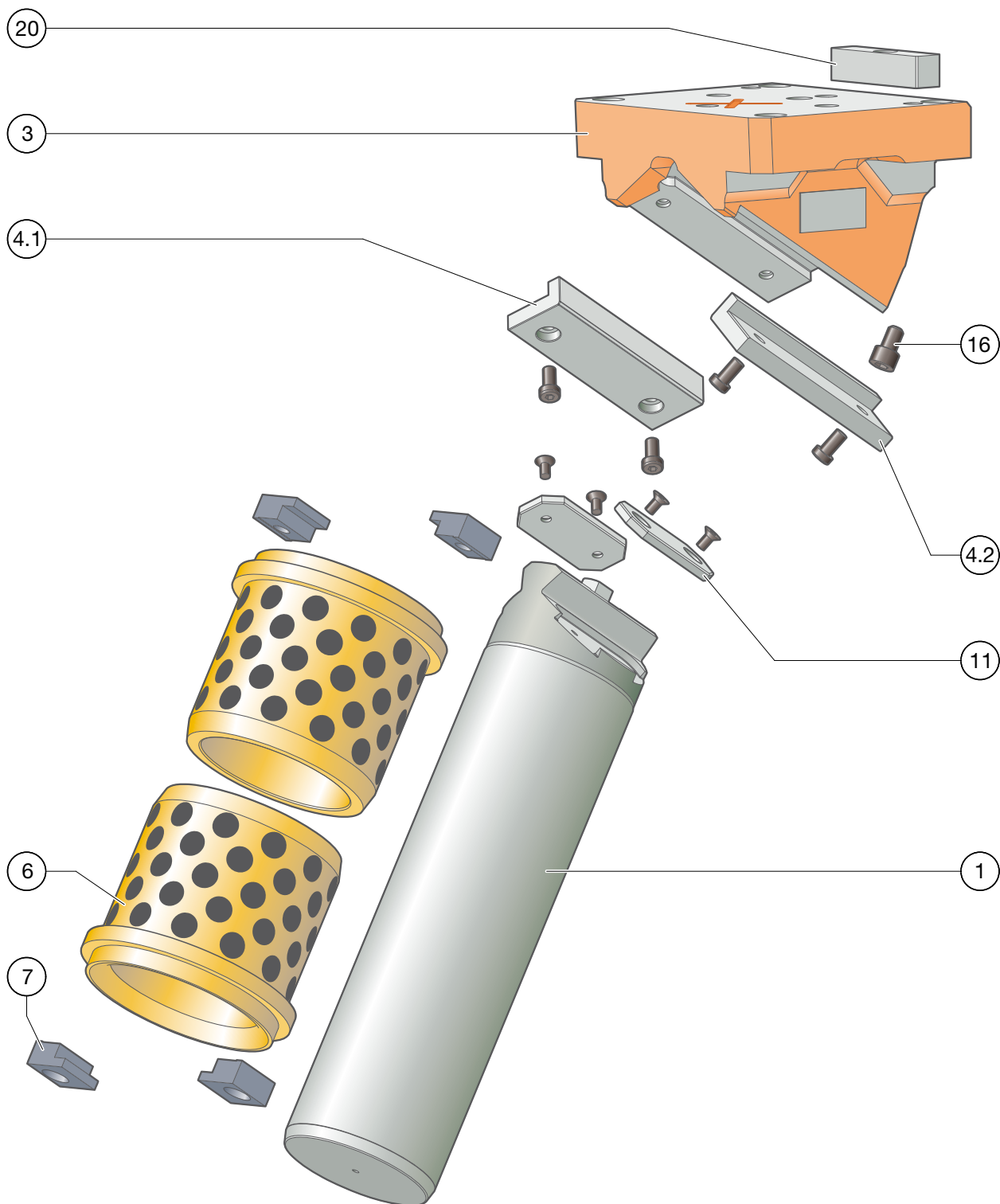

Pillar cam 2019.21.10□□.

Parts list

Item No.	piece	Designation	Material	tuned	Spare part
1	1	Sleeve	1.1221		x
2					
3	1	Cam base	EN-JS-1060		
4.1	1	L-bar left	1.1191 with sinter layer	x	x
4.2	1	L-bar right	1.1191 with sinter layer	x	x
5					
6	2	Guide bushing	Bronze with solid lubricant		x
7	4	Retaining clamp			x
8					
9					
10					
11	2	Sliding plate	1.2379		x
12					
13					
14					
15					
16	1	Drop-out safety			x
17					
18					
19					
20	1	Wedge	1.1191		x

For inquiries / orders of spare parts (x), we require the following data:

Cam unit order no.

Cam unit serial number

Position number / Designation / Spare part

Pillar cam 2019.21.10□□.

System and surrounding forces

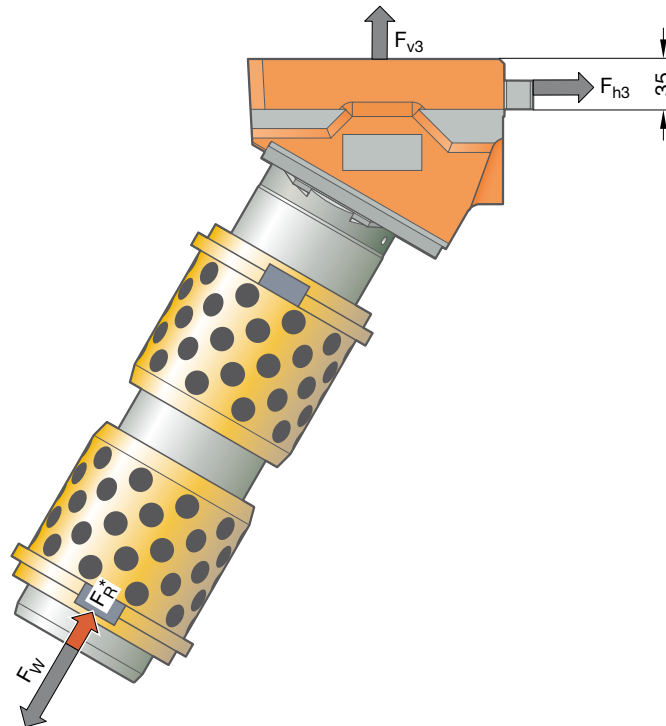

Order No.	α [°]	F_W [kN]	F_R [kN]	F_{h3} [kN]	F_{v3} [kN]
2019.21.1050.01.□□□□.0	50	260	35	181	187
2019.21.1055.01.□□□□.0	55	260	35	164	203
2019.21.1060.01.□□□□.0	60	260	35	146	216
2019.21.1065.01.□□□□.0	65	260	35	126	228
2019.21.1070.01.□□□□.0	70	260	35	106	238
2019.21.1075.01.□□□□.0	75	260	35	85	246
2019.21.1080.01.□□□□.0	80	260	35	63	253
2019.21.1085.01.□□□□.0	85	260	35	41	257

Pillar cam FPC 2019.21.12□□.

Sleeve diameter: 125 mm
Performance class: 350 kN

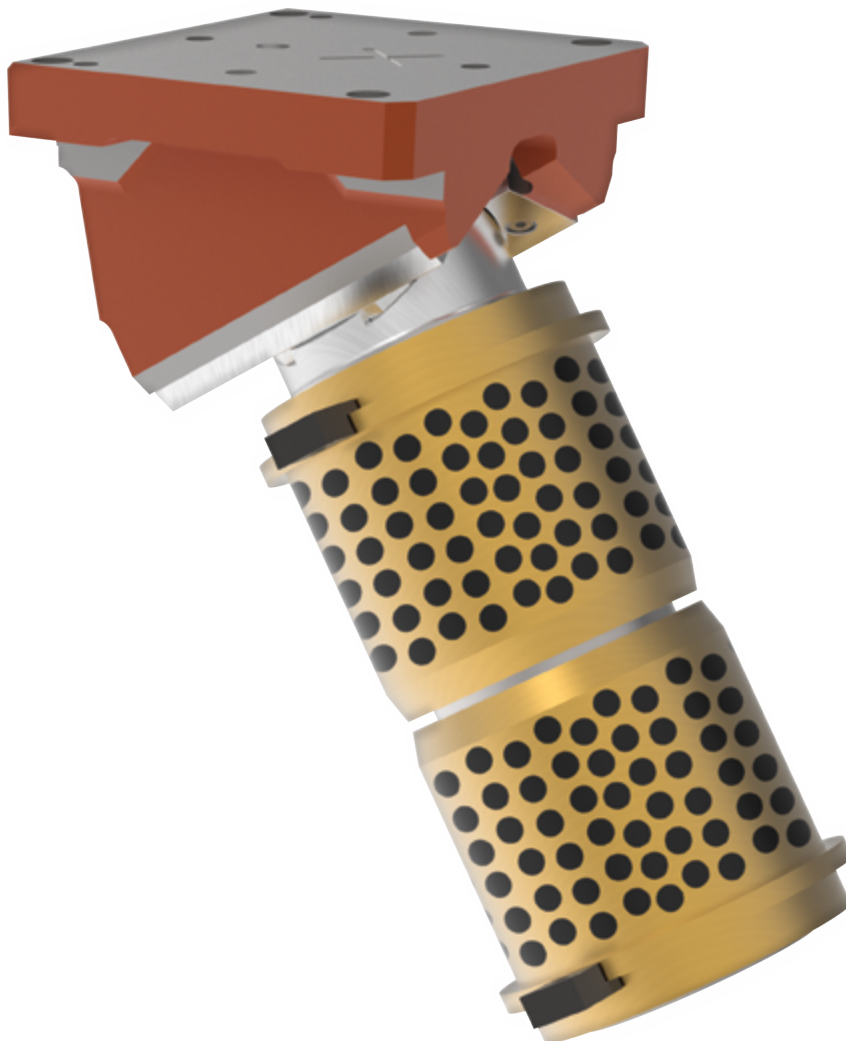

Pillar cam 2019.21.12□□.

Size table

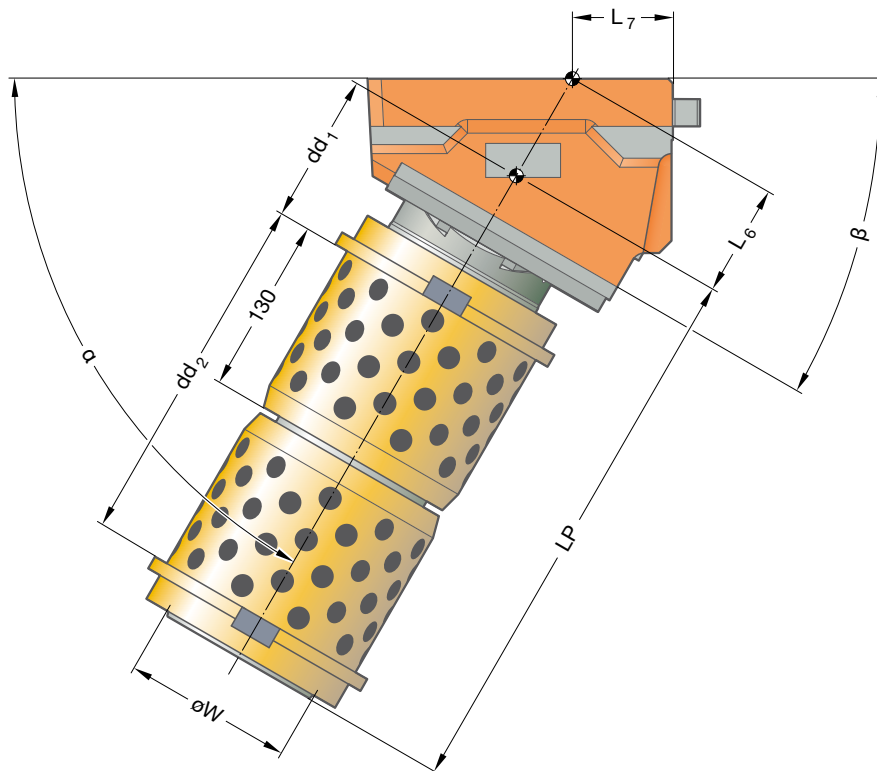
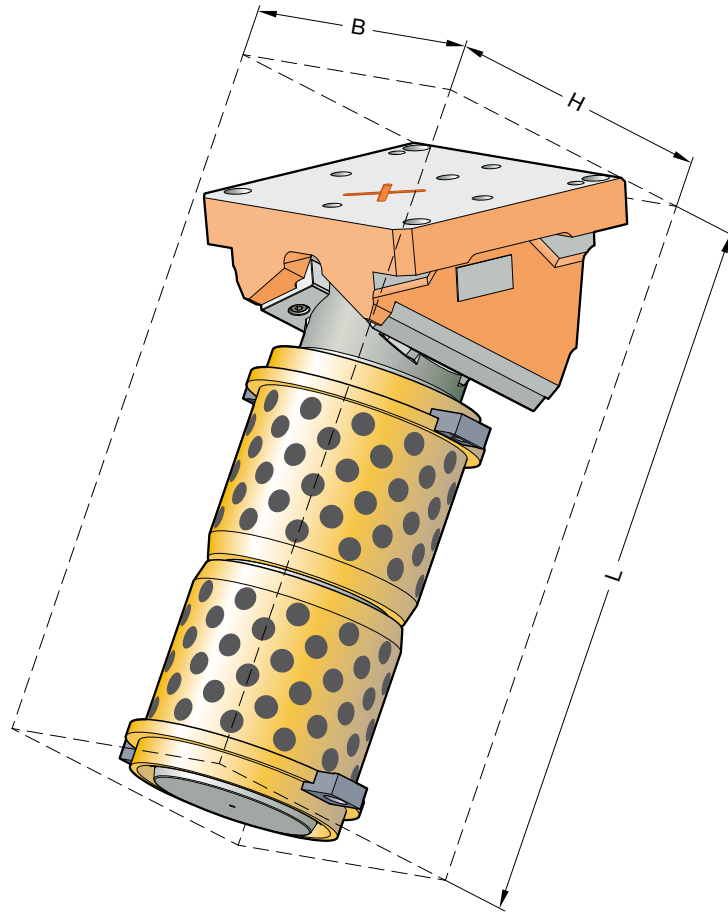

Pillar cam 2019.21.12□□.

Size table

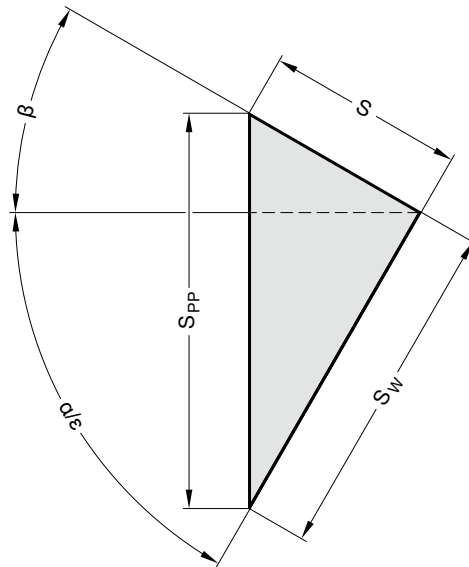

Order No.	L [mm]	B [mm]	H [mm]	øW [mm]	L _p [mm]	L ₆ [mm]	L ₇ [mm]	dd ₁ (min) [mm]	dd ₂ (min) [mm]	α [°]	β [°]	S _W (max) [mm]	S (max) [mm]	S _{PPP} (max) [mm]
2019.21.1250.01.□□□□.0	596	240	269	125	260...450	117,49	79,48	120	265	50	40	81,0	68	105,8
2019.21.1255.01.□□□□.0	591	240	274	125	260...450	109,87	91,98	120	265	55	35	97,1	68	118,6
2019.21.1260.01.□□□□.0	558	240	253	125	260...450	92,38	73,81	120	265	60	30	117,8	68	136,0
2019.21.1265.01.□□□□.0	552	240	256	125	260...450	88,27	82,7	120	265	65	25	145,8	68	160,9
2019.21.1270.01.□□□□.0	545	240	246	125	260...450	85,13	90,88	120	265	70	20	186,8	68	198,8
2019.21.1275.01.□□□□.0	537	240	248	125	260...450	82,82	98,56	120	265	75	15	253,8	68	262,7
2019.21.1280.01.□□□□.0	529	240	235	125	260...450	81,23	105,9	120	265	80	10	385,6	68	391,6
2019.21.1285.01.□□□□.0	520	240	236	125	260...450	80,31	113	120	265	85	5	777,2	68	780,2

Fastening slider bed

	Quantity	Size
Socket cap screws	4	M16
Dowel pins	2	ø12

Fastening of guide bushing

	Quantity	Size
Socket cap screws	2	M10 x Number of bushings
Outside diameter bushing		ø160

Pillar cam 2019.21.12□□.

Exploded view

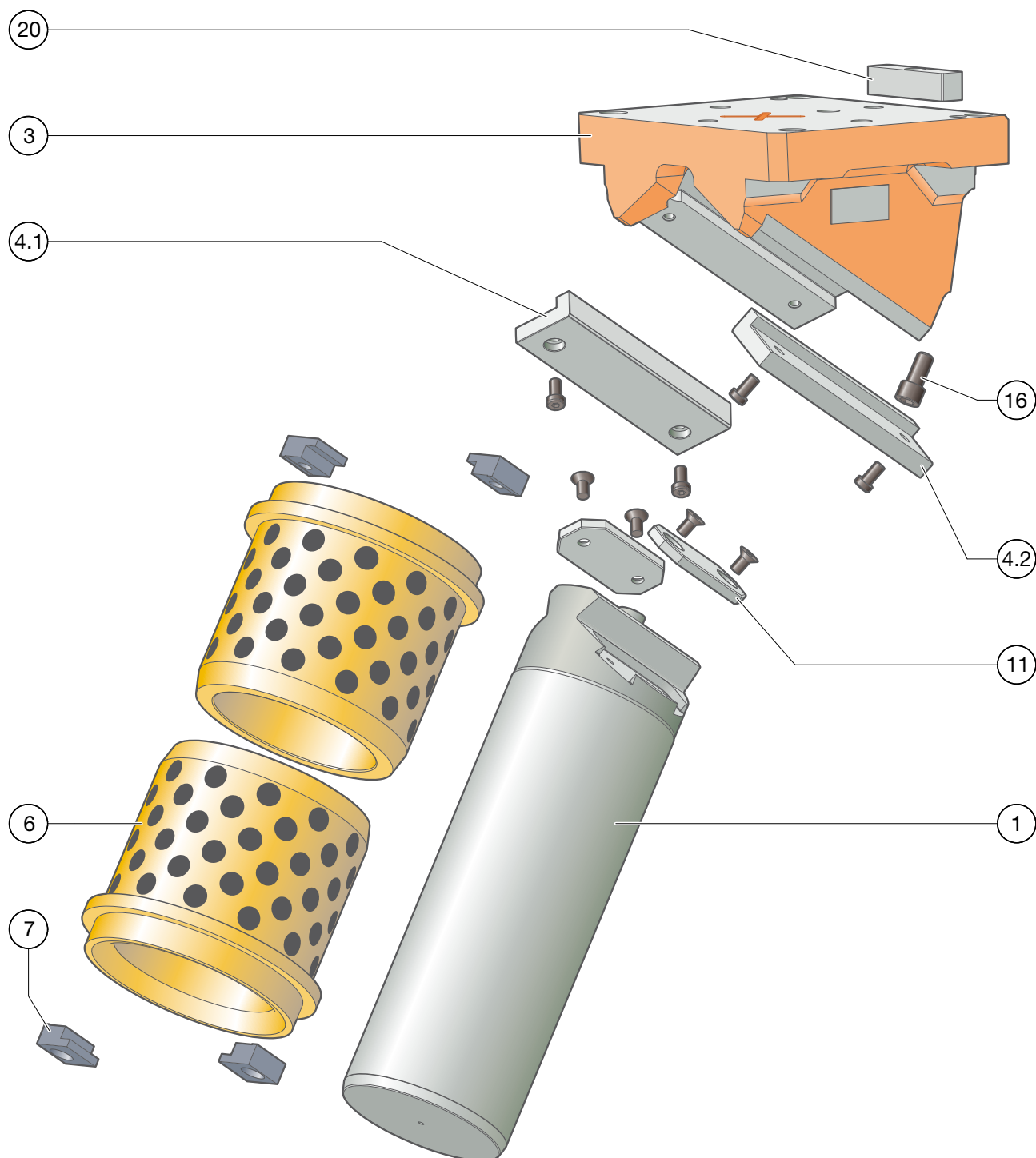

Pillar cam 2019.21.12□□.

Parts list

Item No.	piece	Designation	Material	tuned	Spare part
1	1	Sleeve	1.1221		x
2					
3	1	Cam base	EN-JS-1060		
4.1	1	L-bar left	1.1191 with sinter layer	x	x
4.2	1	L-bar right	1.1191 with sinter layer	x	x
5					
6	2	Guide bushing	Bronze with solid lubricant		x
7	4	Retaining clamp			x
8					
9					
10					
11	2	Sliding plate	1.2379		x
12					
13					
14					
15					
16	1	Drop-out safety			x
17					
18					
19					
20	1	Wedge	1.1191		x

For inquiries / orders of spare parts (x), we require the following data:

Cam unit order no.

Cam unit serial number

Position number / Designation / Spare part

Pillar cam 2019.21.12□□.

System and surrounding forces

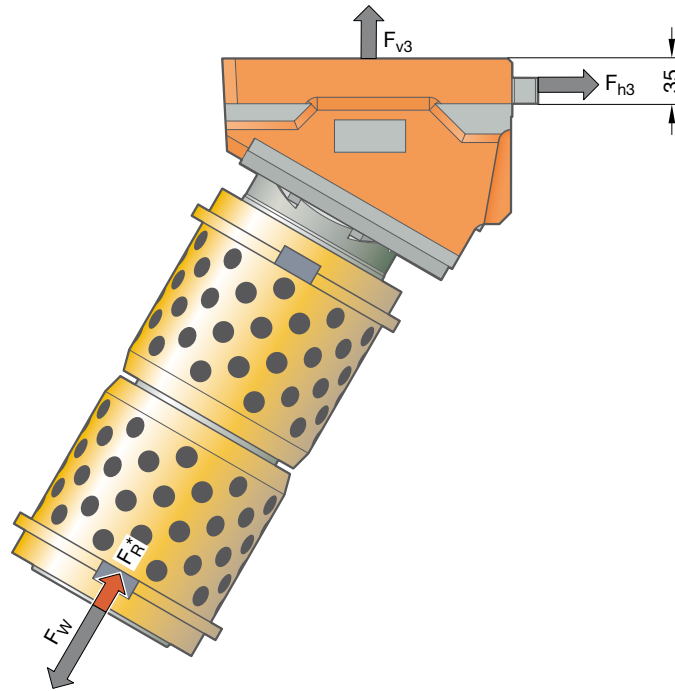

Order No.	α [°]	F_w [kN]	F_R [kN]	F_{h3} [kN]	F_{v3} [kN]
2019.21.1250.01.□□□□.0	50	350	45	244	252
2019.21.1255.01.□□□□.0	55	350	45	221	273
2019.21.1260.01.□□□□.0	60	350	45	196	291
2019.21.1265.01.□□□□.0	65	350	45	170	307
2019.21.1270.01.□□□□.0	70	350	45	143	321
2019.21.1275.01.□□□□.0	75	350	45	114	332
2019.21.1280.01.□□□□.0	80	350	45	85	340
2019.21.1285.01.□□□□.0	85	350	45	55	347

Pillar cam FPC

2019.21.16□□.

Sleeve diameter: 160 mm
Performance class: 500 kN

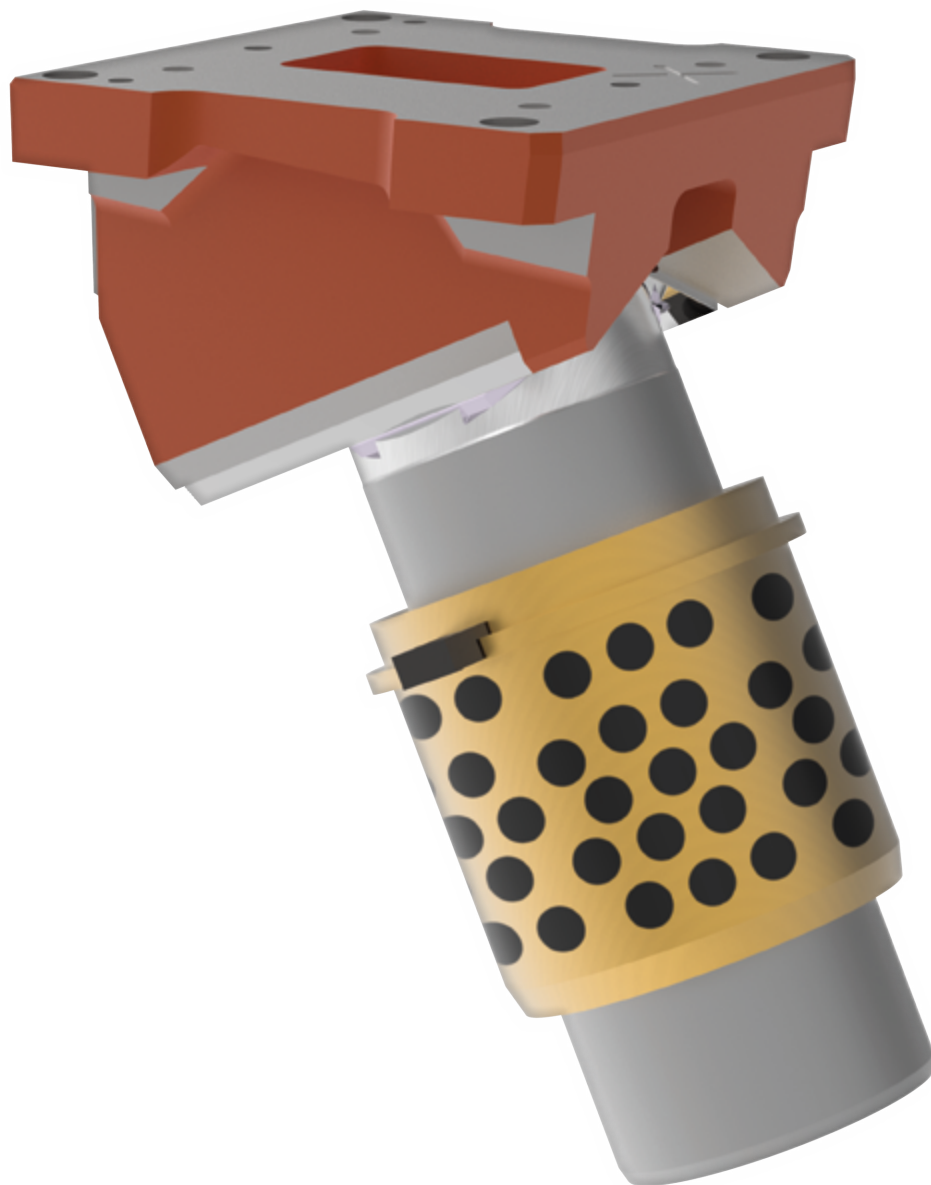

Pillar cam 2019.21.16□□.

Size table

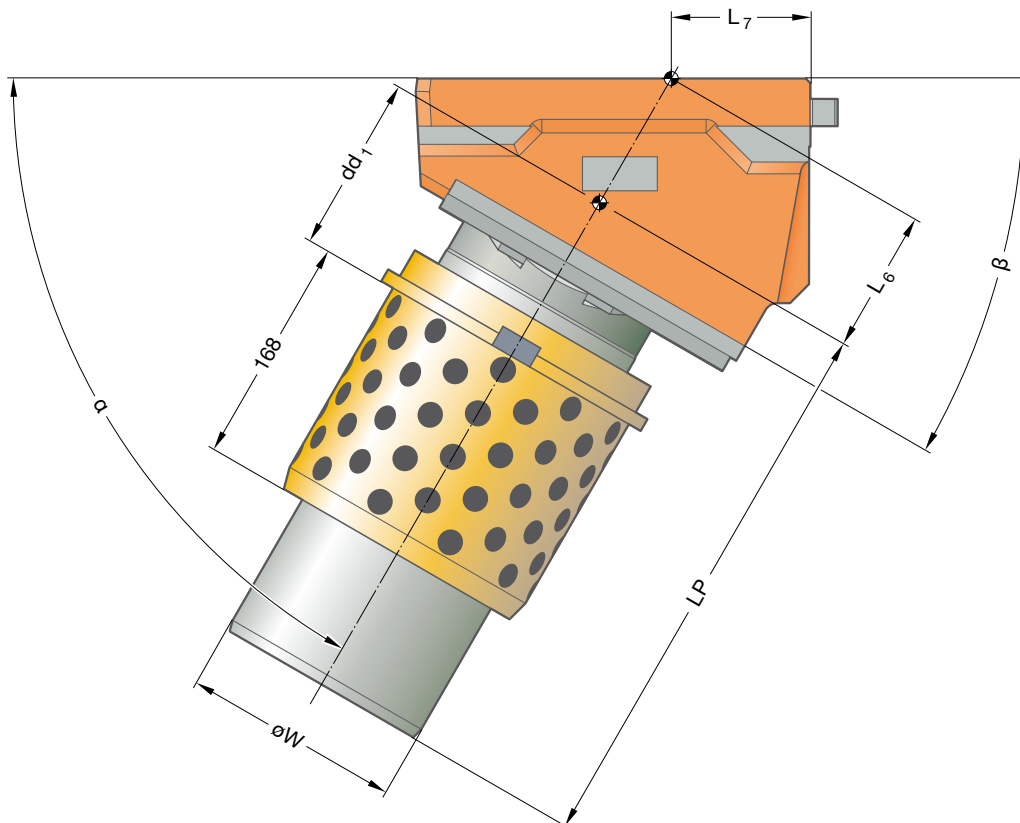
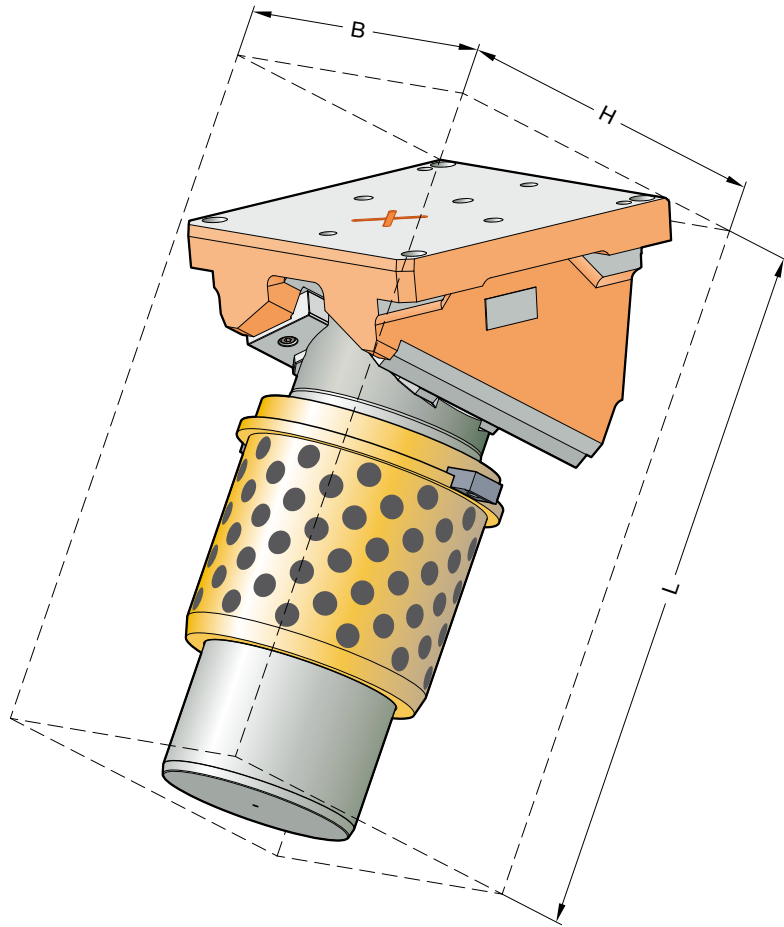

Pillar cam 2019.21.16□□.

Size table

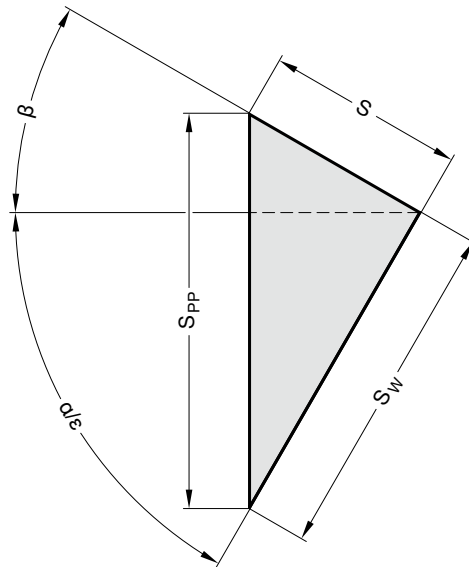

Order No.	L [mm]	B [mm]	H [mm]	øW [mm]	L _p [mm]	L ₆ [mm]	L ₇ [mm]	dd ₁ (min) [mm]	α [°]	β [°]	S _w (max) [mm]	S (max) [mm]	S _{PP} (max) [mm]
2019.21.1650.01.□□□□.0	626	275	327	160	310...450	130,54	106,09	130	50	40	104,9	88	136,9
2019.21.1655.01.□□□□.0	619	275	333	160	310...450	122,08	119,98	130	55	35	125,7	88	153,4
2019.21.1660.01.□□□□.0	595	275	323	160	310...450	115,47	102,27	130	60	30	152,4	88	176,0
2019.21.1665.01.□□□□.0	587	275	328	160	310...450	110,34	113,37	130	65	25	188,7	88	208,2
2019.21.1670.01.□□□□.0	578	275	316	160	310...450	106,42	123,6	130	70	20	241,8	88	257,3
2019.21.1675.01.□□□□.0	567	275	318	160	310...450	103,53	133,21	130	75	15	328,4	88	340,0
2019.21.1680.01.□□□□.0	556	275	303	160	310...450	101,54	142,37	130	80	10	499,1	88	506,8
2019.21.1685.01.□□□□.0	543	275	304	160	310...450	100,38	151,25	130	85	5	1005,8	88	1009,7

Fastening slider bed

	Quantity	Size
Socket cap screws	4	M16
Dowel pins	2	ø12

Fastening of guide bushing

	Quantity	Size
Socket cap screws	2	M10 x Number of bushings
Outside diameter bushing		ø200

Pillar cam 2019.21.16□□.

Exploded view

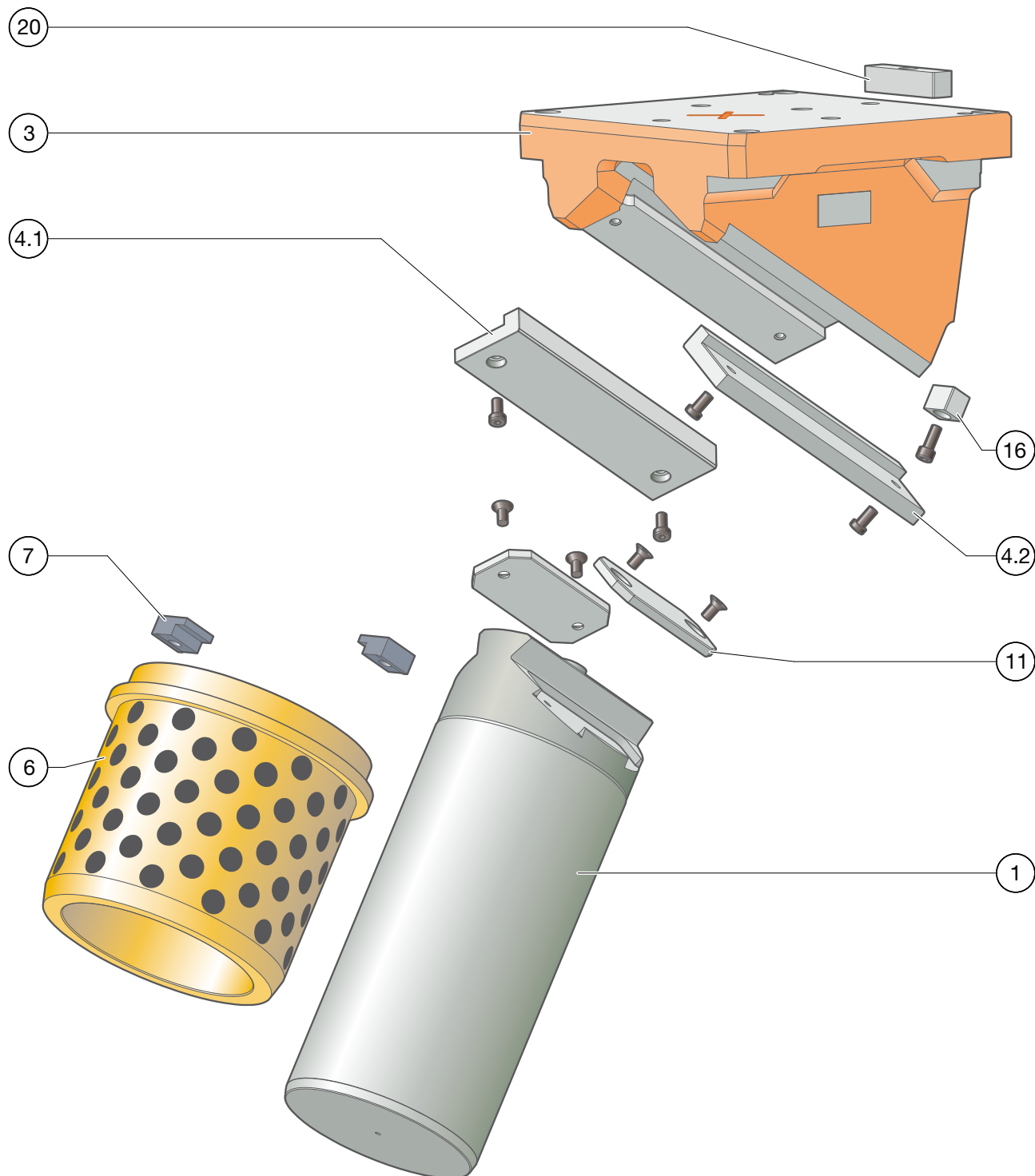

Pillar cam 2019.21.16□□.

Parts list

Item No.	piece	Designation	Material	tuned	Spare part
1	1	Sleeve	1.1221		x
2					
3	1	Cam base	EN-JS-1060		
4.1	1	L-bar left	1.1191 with sinter layer	x	x
4.2	1	L-bar right	1.1191 with sinter layer	x	x
5					
6	1	Guide bushing	Bronze with solid lubricant		x
7	2	Retaining clamp			x
8					
9					
10					
11	2	Sliding plate	1.2379		x
12					
13					
14					
15					
16	1	Drop-out safety			x
17					
18					
19					
20	1	Wedge	1.1191		x

For inquiries / orders of spare parts (x), we require the following data:

Cam unit order no.

Cam unit serial number

Position number / Designation / Spare part

Pillar cam 2019.21.16□□.

System and surrounding forces

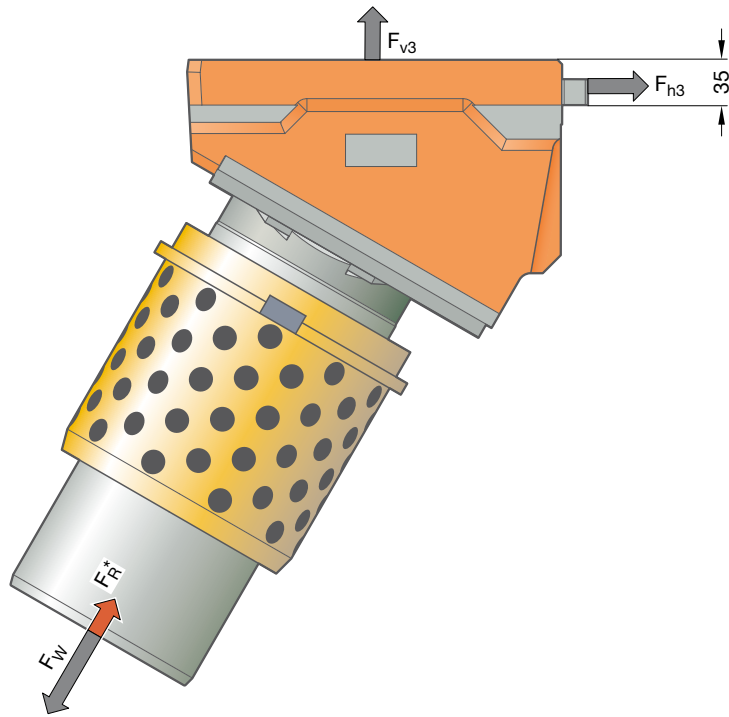

Order No.	α [°]	F_w [kN]	F_R [kN]	F_{h3} [kN]	F_{v3} [kN]
2019.21.1650.01.□□□□.0	50	500	65	348	361
2019.21.1655.01.□□□□.0	55	500	65	315	390
2019.21.1660.01.□□□□.0	60	500	65	280	416
2019.21.1665.01.□□□□.0	65	500	65	243	438
2019.21.1670.01.□□□□.0	70	500	65	204	458
2019.21.1675.01.□□□□.0	75	500	65	163	474
2019.21.1680.01.□□□□.0	80	500	65	121	486
2019.21.1685.01.□□□□.0	85	500	65	78	495

Assembly instructions

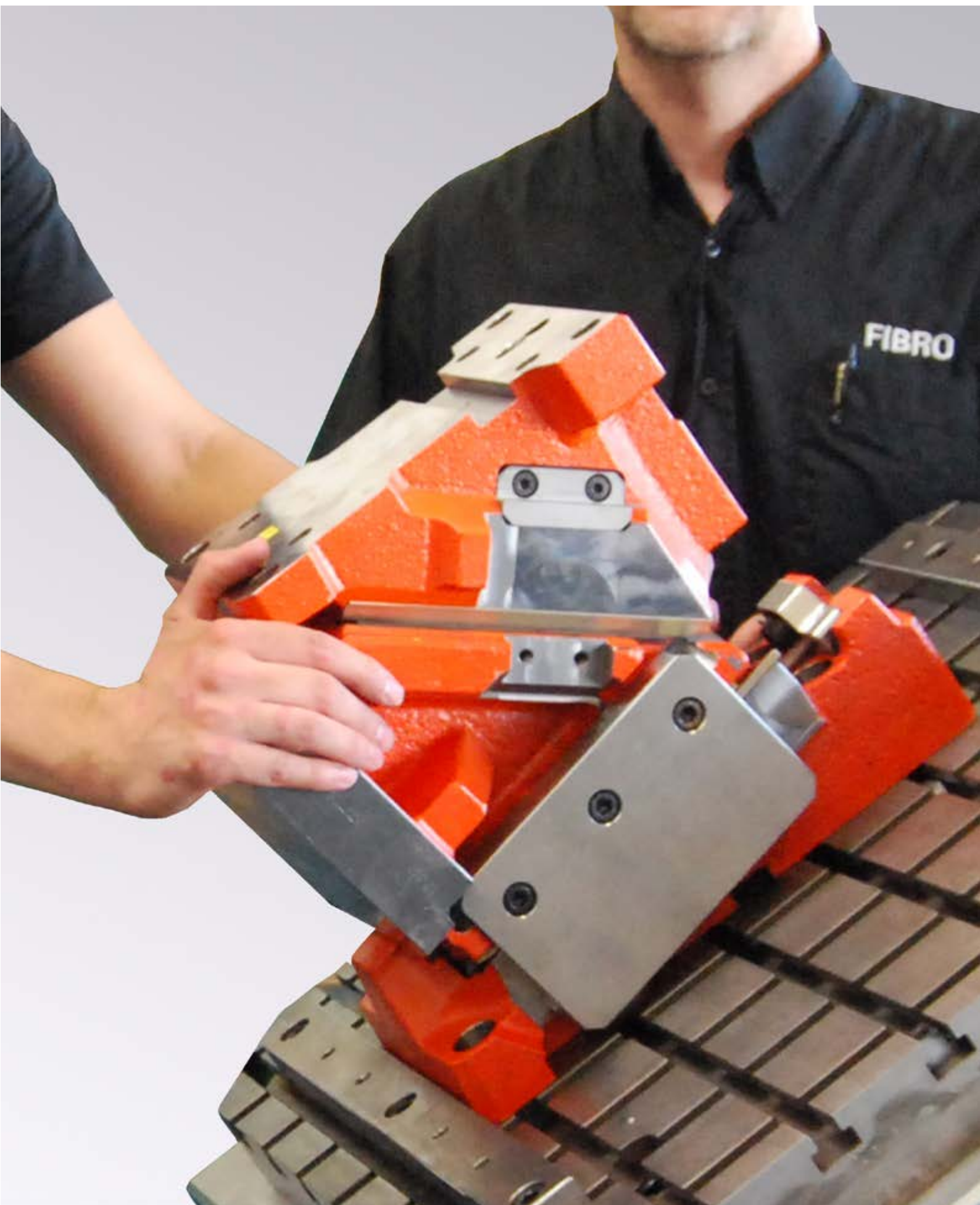

Pillar cam 2019.21. Assembly instructions

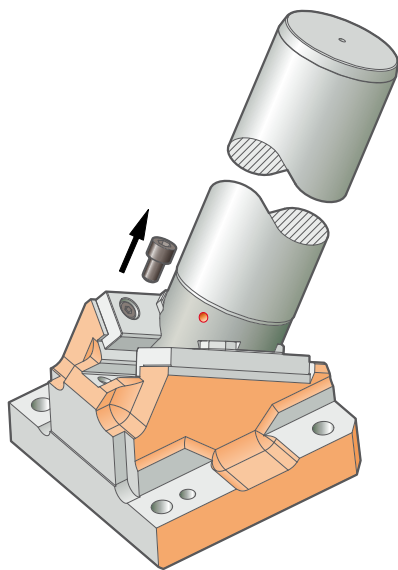

Step 1

- Remove the drop-out safety.

Caution

After the removal of the drop-out safety the sleeve can be removed unimpeded. That is why we recommend for reasons of work safety to remove the drop-out safety only when the slider does not stand overhead..

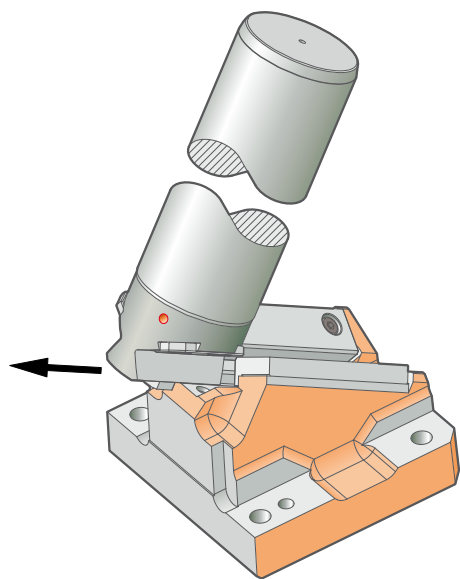

Step 2

- Remove the sleeve towards the rear.

Pillar cam 2019.21. Assembly instructions

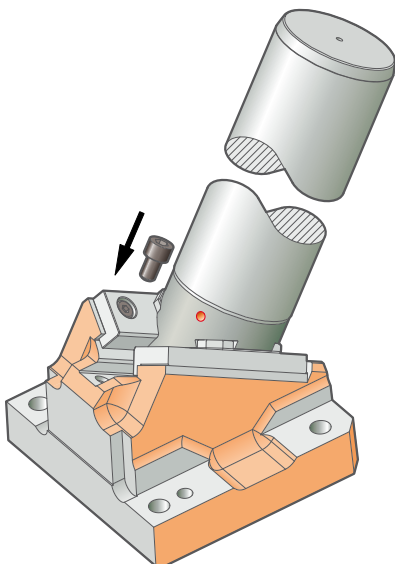
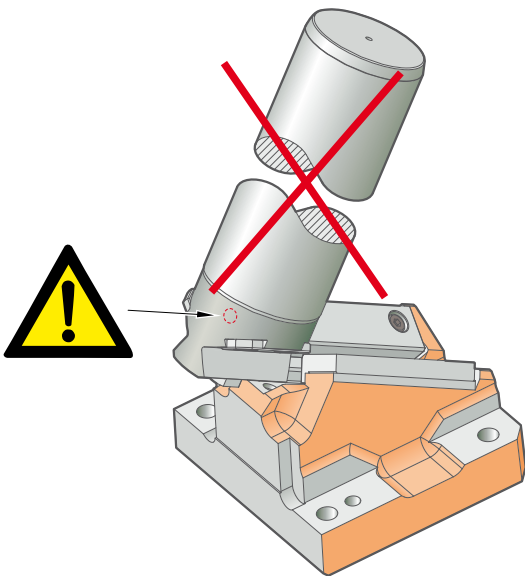
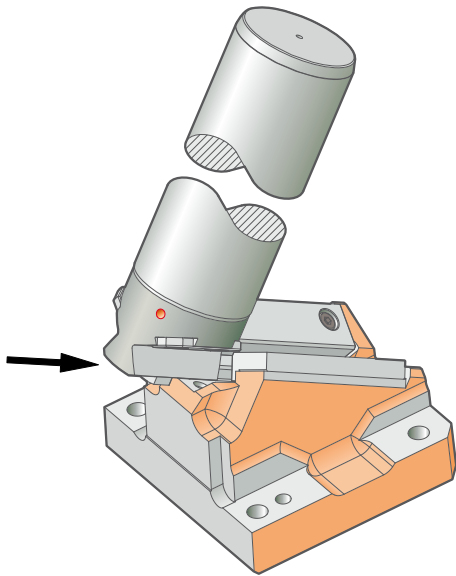

Step 3

- After concluding work, insert the sleeve again into the slider bed.

Caution

Avoid damage to the sinter sliding surfaces by inserting the sleeve into the guide without as much tilting as possible.

Information

A 180° turned installation of the sleeve is not possible due to the constructive design of the guide. Observe here too, that the optical control borehole must point to the rear.

Step 4

- Insert the drop-out safety.

Caution

The drop-out safety prevents the self-acting drop-out of the sleeve from the top part of the tool during the dismantling of the slider. It contributes much to the work safety and must be definitely taken into consideration during mounting. The screw for the drop-out safety must be secured against coming loose with screw fixing adhesive.

Pillar cam 2019.21. Assembly in the tool

Sleeve sliders of series 20.19.21 are installed in the tool according to the common home-made solutions via the base of the upper part of the tool. The removal via the hold-down device is not possible.

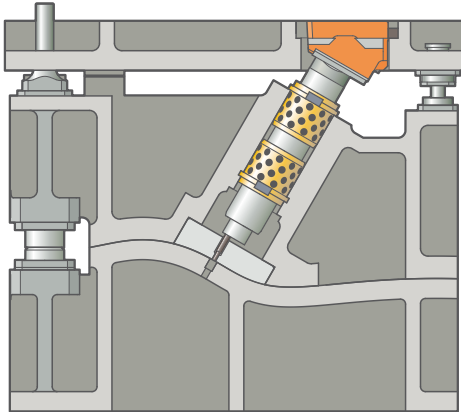

Step 1

Tool in work position.

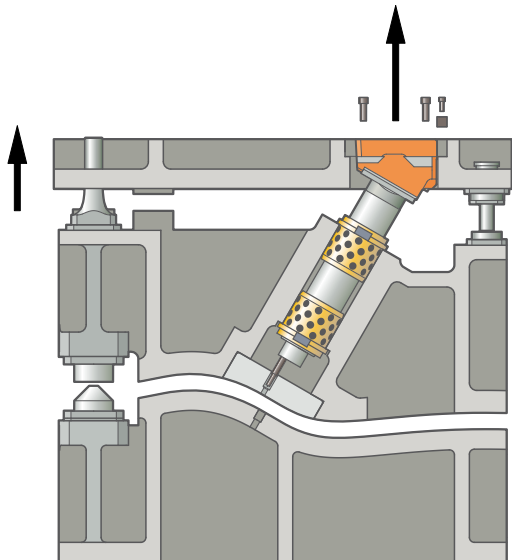

Step 2

Before removing the sleeve slider the tool must be relieved, or the top part separately positioned on the distance blocks.

The hold-down device should hang relieved in the holding elements.

Loosen the mounting aid wedge, pins and screws of the slider bed on the base of the upper part of the tool.

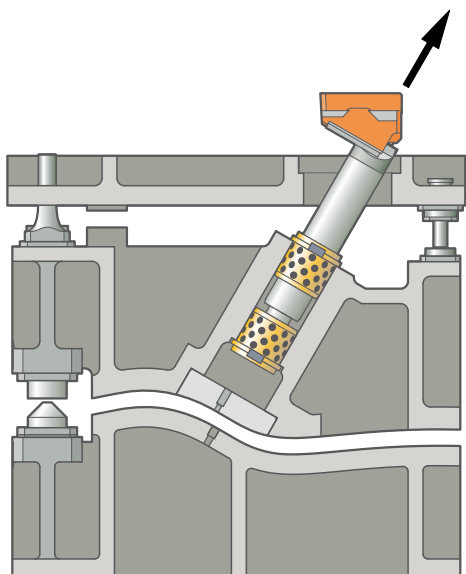

Step 3

Pull the sleeve slider unit out of the tool backwards through the top part of the tool. For this the extraction thread in the slider bed can be used as an aid.

Caution

Ensure during the removal that the sleeve in the tool is not tilted. This could cause damage to the sleeve or other tool components.

Pillar cam 2019.21. Prefabrication

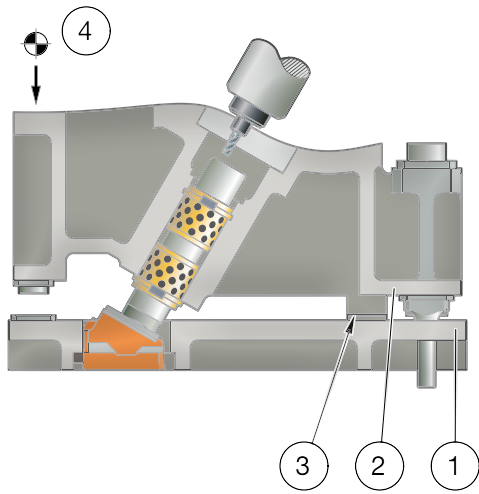

The prefabrication of the sleeve slider happens advantageously during assembly of the top half of the tool. The hold-down device (2) must be distanced and fixed to the upper part (1) in the closed tool position (3). In this package it is possible to use the mounting holes of the hold-down device (4) to determine the precise position of the component and with it the position of the prefabrication.

www.fibro.com

FIBRO GmbH
Business Unit Standard Parts
August-Läpple-Weg
74855 Hassmersheim
GERMANY
T +49 6266 73-0
info@fibro.de

precision +++
is our +++
standard +++

Order No. 2.2919.00.0824.0100000